



**認定日本語教育機関 留学**  
Nationally Accredited Japanese language educational institutions for Study in Japan

**The Osaka YMCA Gakuin**

## Application Guide

Osaka YMCA was founded in 1882, with the aim of fulfilling the Biblical phrase, "Bring all the people as one", by transcending nationality, ethnicity, religion and belief. Osaka YMCA Gakuin was established in 1969 with the vision of the development of mutual understanding between people from different cultural backgrounds. Over 50 years, it has enabled people to develop a high level of language proficiency and to truly play an active role as a global citizen. We support each individual student to fulfill his or her purpose of life. We instruct students wholeheartedly with the desire that they will grow to be a dedicated member of a harmonious society.

### Preparatory Japanese Course for Higher Education

Please refer to page 3 for further details.

**We will develop high-level communication skills and provide detailed career guidance and preparation according to the goal of each student.**

This course is for those who aim to go to university in Japan. The easy-to-learn curriculum will develop advanced Japanese-language skills as well as academic skills such as "short essays" and "presentations" that will be necessary after entering the university. Furthermore, we will focus on preparation for the Japanese Language Proficiency Test (JLPT) and the Examination for Japanese University Admission for International Students (EJU). In addition, students can study English, which is necessary in all fields of university entrance exam, and Basic drawing, which is necessary in the art field, as elective subjects. We will also provide detailed career consultation services and career guidance tailored to each student's desired career path through weekly homeroom activities and interviews.

**Preparatory Education Curriculum - Approved by the Japanese Ministry of Education, Culture, Sports, Science and Technology**

- Students who have completed 10 or 11 years of primary and secondary education that require a preparatory course can also enter. To enter a Japanese university, you must have completed 12 years or more of school education abroad. However, in some countries and regions, the period required to complete high school is less than 12 years, and you are not eligible to apply to a university in Japan. Even in such cases, if you have completed a "course of preparatory education for entering university" designated by the Ministry of Education, Culture, Sports, Science and Technology and have reached the age of 18, you will be eligible to apply to a university. In our school's Japanese for University Admissions Course, you can obtain this "preparatory course." Please contact us if you need it.

### Practical Japanese Course for Career Development

Please refer to page 5 for further details.

**This course is for developing your business communication skills, by preparing for employment and improving language skills, also deepening your understanding of different cultures.**

This course is for improving the language skills required for job hunting and business scenes. In addition, you will understand different cultures and improve your business communication skills in order to play on a global stage. In a beginner to intermediate class, in addition to basic Japanese language learning, you will intensively and effectively improve your Japanese language skills in "listening/speaking", "reading/writing". In the advanced class, half of the classes are elective subjects, and you can choose five subjects from the fields of "academic", "business", and "culture". Furthermore, job seekers at the intermediate level or above can receive professional guidance from career consultants on how to write resumes and application forms, how to take interviews, and how to proceed with job hunting.

# I . Application Procedure (For Student Visa)

## ① Apply to the YMCA

### ( 1 ) Domestic Application

Please make an appointment before submitting your application form or taking an interview.

We may refuse to accept an application form or an interview if you do not have an appointment.

Prepare all the necessary documents (please refer to the Application Instructions). They must be submitted by a representative on your behalf to the reception desk of the Osaka YMCA Gakuin.

### ( 2 ) Overseas Application

For details on the procedures for applying through our subcontracted agencies, please inquire the partner institutions listed on our school's website.

<https://osakaymca.ac.jp/nihongo/en/enrollment/overseas-office.html>

## 1 . Eligibility for Application

Those who fulfill conditions (A), (B) or (C).

(A) High school or upper secondary education graduates. Otherwise, those who have been certified as having equivalent or higher academic ability.

Preparatory Japanese Course for Higher Education: Applicants from countries where the school system requires less than 12 years of education to graduate from high school are also eligible to apply.

In this case, applicants must be eligible to apply to university in your home country.

(B) Japanese language level at the time of admission to the Preparatory Japanese Course for Higher Education:

1-year (B1-B2) course: Applicants who can prove their Japanese language level equivalent to A2 of the "Japanese Language Education Reference Frame," such as JLPT N3 or higher level. Otherwise, those who have studied Japanese for more than 350 hours at a school or language education institution at the time of application.

1.5-year (A1-B2) and 2-year (A1-B2) courses: Applicants who can prove their Japanese language level equivalent to A1 of the "Japanese Language Education Reference Frame," such as JLPT N5. Otherwise, those who have studied Japanese for more than 150 hours at a school or language education institution at the time of application.

(C) Japanese language level at the time of admission to the Practical Japanese Course for Career Development:

1.5-year Career readiness Program (J1:A1.2-J6:B2.1) and 2-year course (J1:A1.2-J8:B2.2):

Those who can prove their Japanese language ability equivalent to the "reference frame for Japanese language education" A1, such as JLPT N5, or those who have studied Japanese for more than 150 hours at a school or language education institution at the time of application.

1-year Career readiness Program A (J6:B1.2-J9:C1.1): Those who can prove their Japanese language level equivalent to the "reference frame for Japanese language education" B1, such as JLPT N2 or higher level. Otherwise, those who have studied Japanese for more than 600 hours at a school or language education institution at the time of application.

1-year Career readiness Program B (J3:A2.2-J6:B2.1): Applicants who can prove their Japanese language level equivalent to A2 of the "Japanese Language Education Reference Frame," such as JLPT N4 or higher level. Otherwise, who have studied Japanese for more than 300 hours at a school or language education institution at the time of application.

1-year Intensive Japanese Program (J1:A1.2-J4:B1.2): Applicants who can prove their Japanese language level equivalent to A1 of the "Japanese Language Education Reference Frame," such as JLPT N5. Otherwise, who have studied Japanese for more than 150 hours at a school or language education institution at the time of application.

## 2 . Application Period

	Preparatory Japanese Course for Higher Education		Practical Japanese Course for Career Development	
	Bangladesh, Vietnam, Mongolia, Nepal, Myanmar, Sri Lanka, Philippines, India	Other nationalities not listed to the left	Bangladesh, Vietnam, Mongolia, Nepal, Myanmar, Sri Lanka, Philippines, India	Other nationalities not listed to the left
Enrollment in April	Late Aug.-Early Nov.	Late Aug. - Mid-Nov.	Late Aug. - Early Nov.	Late Aug. - Mid-Nov.
Enrollment in July	-	-	Mid-Dec. - Early Mar.	Mid.-Dec. - Mid.-Mar.
Enrollment in October	Late Feb.- Early May	Late Feb. - Mid.-May	Late Feb. - Early May	Late Feb. - Mid.-May
Enrollment in January	-	-	Early June - Early Sep.	Early June - Mid.-Sep.

\* Those who have obtained a visa other than a student visa can apply up until the end of the month preceding the start of the semester.

\* The application period will be closed when the maximum number of students has been accepted.

### 3 .Application Documents Please refer to the Application Instructions.

## ! Course Selection

The Osaka YMCA Gakuin provides two courses for the needs of our students.  
You will not be allowed to change courses after submitting the application form.  
Please be fully aware of the features of each course before applying.

### In-School Screening & Selection

- Applicants will be accepted based on the results of the screening of application documents and other reviews.
- Results will be sent by e-mail after the in-school screening.

Enrollment	April	July	October	January
In-school screening Result				
Period of application to the immigration office	Late Nov.	Mid Mar.	Late May	Early Oct.
Result from the immigration office	Next Late Feb.	Late May	Late Aug.	Mid Nov.

### Applying at the Immigration Office

- The Osaka YMCA Gakuin Administration Office will apply for a Certificate of Eligibility at the Immigration Office for all those who are accepted.
- It usually takes three months for the Immigration Office to process the application documents.

### Announcement of visa application result Issuing a Certificate of Eligibility

- When the Immigration Office approves the application, the Certificate of Eligibility will be sent directly to the school.
- The administration office will send a tuition invoice to successful applicants.
- The administration office will send the Certificate of Eligibility, after confirming the payment of tuition.

## ② Obtaining a Visa

- Applicants need to apply for a visa at the Japanese Embassy or Consulate in their home country. You need to bring your Certificate of Eligibility, the letter of acceptance, and your passport.
- The time taken for processing an application to issue a visa varies between diplomatic establishments in each country.
- The Certificate of Eligibility is valid for three months after the date of issue.
- For applicants who want to live in accommodations recommended by the Osaka YMCA should apply before entrance.

## ③ Arrival in Japan / Entrance Ceremony / Orientation

- An orientation seminar and a level test will be conducted before the course begins.
- We will conduct orientation seminars relating to the opening of a bank account, buying a cell phone, and finding part-time work.

## ④ Class Begins

## II. Preparatory Japanese Course for Higher Education

<b>Enrollment</b> <b>April</b> (1-year course / 2-year course) <b>October</b> (1.5-year course)	<b>Maximum Number of Students</b> 160	<b>Class Schedule</b> Monday - Friday 9:00am ~ 2:40pm 5 classes per day
<b>Suitable for</b>	People who aim to go to University / College / Graduate School in Japan	
<b>Course Length and Level</b>	1-year course, 1.5-year course, 2-year course Beginner, Intermediate, Advanced, Upper Advanced	
	First year	Second year
Enrollment in <b>April</b>	2-year Course	Beginner 1・2    Pre-Intermediate Intermediate 1    Intermediate 2 Upper Intermediate    Advanced 1・2 Intermediate    Upper Intermediate    Advanced    Upper Advanced
	1-year Course	Intermediate    Upper Intermediate
Enrollment in <b>October</b>	1.5-year Course	Beginner    Pre-Intermediate    Intermediate
		Intermediate    Upper-Intermediate    Advanced

### ● Curriculum (875 hours per year)

1. Basic Japanese (Beginner 1~Advanced 2 : 14 hours per week)
  - ★ We focus on establishing a strong foundation in the basics of Japanese, including characters, vocabulary, and grammar, aiming to enhance fundamental skills that connect to language activities such as reading, writing, listening, and speaking.
2. Language Activities Subject (Beginner 1~ Pre-intermediate : 8 hours per week)
  - ★ Through activities using language needed in daily life, school, and preparation for further education including listening, reading, speaking (presentations and interactions), and writing. We aim to enhance the communication skills of each learner.
3. Japanese Characters・Vocabulary・Pronunciation (Beginner 1~Pre-intermediate : 2 hours per week)
  - ★ This course strengthens the foundational skills in characters and vocabulary, which are essential for using Japanese. Since students from Kanji and non-Kanji backgrounds have different learning methods and progress rates, classes at this level are divided accordingly. However, the goal remains the same for both classes.

4. Academic Japanese (Advanced 2 : 4 hours per week)
    - ★ This course focuses on building the foundational skills necessary for studying specialized fields after advancing to higher education. Students will learn methods for listening to lectures, reading texts in specialized fields, participating in discussions and presentations, and writing essays and reports. These skills are practiced progressively.
  5. Project work (Advanced 2 : 6 hours per week)
    - ★ Towards graduation, students prepare to present their learning achievements through collaborative projects with their peers. Activities such as "theater performances", "group recitations", and "video production" help students refine their expressive abilities in various forms.
  6. Elective Subjects (Intermediate 1~Advanced 1 : 10 hours per week)
    - ★ Students can select subjects tailored to their respective paths, whether vocational schools, universities, or graduate schools, and prepare for the necessary entrance exams. A wide range of subjects are offered, including preparation for JLPT, EJU, research proposals, and basic drawing.
- ☆ Students required to complete the preparatory education program must take 40 hours per year for each of the following subjects: Japanese Studies, English, Mathematics I, and, depending on their field, Physics and Chemistry (for Science) or Geography and Civics (for Humanities). Including elective courses (34 hours) and intensive lectures during long vacations (6 hours), the program can be completed within 6 months.

《Sample Timetable for Intermediate 1》

		Monday	Tuesday	Wednesday	Thursday	Friday
1	9:00-9:50	Basic Japanese	Basic Japanese	Basic Japanese	Basic Japanese	Basic Japanese
2	10:00-10:50	Basic Japanese	Basic Japanese	Basic Japanese	Basic Japanese	Basic Japanese
3	11:00-11:50	Basic Japanese	Basic Japanese	Basic Japanese	Basic Japanese	Homeroom
	11:50-12:50	Lunch Break				
4	12:50-13:40	Elective Subjects: EJU Preparation	Elective Subjects: Basic Drawing	Elective Subjects: JLPT Preparation	Elective Subjects: English	Elective Subjects: JLPT Preparation
5	13:50-14:40	Elective Subjects: EJU Preparation	Elective Subjects: Basic Drawing	Elective Subjects: JLPT Preparation	Elective Subjects: English	Elective Subjects: JLPT Preparation

● Homeroom

To ensure a fulfilling daily life in a safe and secure environment and to help students pursue their desired career paths, we provide fundamental knowledge and information on life management, study management, career planning, and cross-cultural understanding. Additionally, students are given opportunities to receive guidance on their living conditions and academic progress.

● Career Guidance

Experienced teachers provide individual consultations and offer careful support tailored to each student's career path, guiding them until they have successfully chosen their next educational institution.

**Financial support is available for the Preparatory Japanese Course for Higher Education**

● Scholarships

After having completed 6 months of study or more, students who excel at class work can apply for the Osaka YMCA International Scholarship or JASSO Scholarship.

● Student Commuter Pass

Students planning to study for 1 year or more at the Osaka YMCA are eligible to apply for a student discount for a commuter pass.

### III. Practical Japanese Course for Career Development

<b>Enrollment</b>  4 times per year April, July, October, January (All 1-year course, 1.5-year course 2-year course)	<b>Maximum Number of Students</b>  340	<b>Class Schedule</b>  Morning Class Monday-Friday 9:00am -12:50pm <u>4 classes per day</u>  Afternoon Class Monday-Friday 1:30pm - 5:20pm <u>4 classes per day</u>
<b>Suitable for</b>	People who want to work in a job that requires Japanese, learn Japanese for business situations, or further enhance their Japanese language skills.  The job preparation course is for individuals whose highest level of education is a university degree or higher.	
<b>Course Length and Level</b>	You can choose from the following course durations. <b>1-year course</b> (Career readiness Program A: J6-J9 · B: J3-J6 / Intensive Japanese Program: J1-J4) <b>Career readiness Program 1.5-year course (J1-J6)</b> <b>Career readiness Program 2-year course (J1-J8)</b> *With a residence status other than "Student", short-term enrollment of less than one year is also available. ※ Make up class between the morning and afternoon sessions are not allowed. You can only attend one of the classes. ※ Please indicate your preferred class time when applying. However, please note that the school will determine the class schedule based on the order of applications and the results of the class placement test. Therefore, it may not be possible to attend your preferred class time.	

● Curriculum (768 hours a year) ... 1 semester (3 months) 192 hours × 4 semester

< < Open level and Timetable > >

	1 <sup>st</sup> Semester	2 <sup>nd</sup> Semester	3 <sup>rd</sup> Semester	4 <sup>th</sup> Semester
J9(C1.1)	Basic Japanese (10 hours / Week)		Elective Subjects (10 hours / Week) • Academic Course • Business Course • Culture Course	
J8(B2.2)				
J7(B2.1~B2.2)				
J6(B1.2~B2.1)	Basic Japanese (15 hours / Week)		Language activities Subjects (5 hours / Week)  Reading • Writing Speaking • Listening Characters • Vocabulary	
J5(B1~B2)				
J4(B1.1~B1.2)				
J3(A2.2~B1.1)				
J2 (A2.2)				
J1 (A1.2~A2.1)				
IJ (A1.1) ※				

※IJ level may be opened as needed.

## 1 . Basic Japanese

Using textbooks appropriate for each level, we focus on reinforcing the foundational elements of Japanese, including characters, vocabulary, and grammar. This helps build the basic skills necessary for language activities such as reading, writing, listening, and speaking.

## 2 . Language activities subjects

We aim to enhance communication skills through activities using language necessary for daily life, school, and work situations such as listening, reading, speaking (interactions), speaking (presentations), and writing.

## 3 . Elective Subjects (Academic・Business・Culture)

In academic subjects, we cultivate the necessary skills for engaging in intellectual activities that require advanced Japanese. This includes preparation for JLPT. In business subjects, we develop the communication skills necessary for business situations. In culture subjects, students deepen their understanding of Japanese traditional culture and pop culture while enjoying them. These activities also provide an opportunity to experience the richness of the Japanese language.

<b>A. Academic Course</b> · Logical Thinking Training · Preparation for JLPT · Reading Documents · Writing Documents · Debate etc....	<b>B. Business Course</b> · Business manner · Business Documents · Business knowledge · The First Step in Job Hunting · Business communication etc....	<b>C. Culture Course</b> · Learning Japanese Through Manga and Anime · Kansai dialect · Reading Novels etc...
---	--	---

The elective courses offered vary each semester.

---

### **Financial support is available for the Practical Japanese Course for Career Development**

- Scholarships

After having completed 6 months of study or more, students who excel at class work can apply for the Osaka YMCA International Scholarship or JASSO Scholarship.



Due to transportation regulations, students in the Practical Japanese Course for Career Development are not eligible to purchase commuter passes.

It is recommended that students in this program stay in accommodation close to the school.

# IV. Tuition

## 1. Tuition Total (Japanese Yen)

Course	Duration	Total	Breakdown				
			Application Fee	Enrollment Fee	Class Fee	Student 24 hours Mutual Insurance	Printing Fee
Preparatory Japanese Course for Higher Education (875 hours a year)	2-years	1,710,000	20,000	100,000	1,560,000	14,000	16,000
	1-year and 6 months	1,312,600			1,170,000	10,600	12,000
	1-year	915,000			780,000	7,000	8,000
Practical Japanese Course for Career Development (768 hours a year)	2-years	1,630,000			1,480,000	14,000	16,000
	1-year and 6 months	1,252,600			1,110,000	10,600	12,000
	1-year	875,000			740,000	7,000	8,000

Notice ① Those who take the Preparatory Education Program need to take “an intensive course” during summer and autumn break. It will cost ¥ 60, 000 additional class fee.

② The cost of textbooks is collected after your class placement. (About ¥ 5,000 for each semester)

③ Please refer to the support section on page 8 about the details of the Student Life Support System.

## 2. Payment Methods

Please use Flywire to transfer the tuition fees. You can pay with local currency or credit card from Flywire website.



※Note :

- Please check the Flywire website for input method. The address of the website will be written on the tuition invoice.
- Depending on overseas agency, you may have to pay in advance. Please confirm with them for more information.

## 3. Refund

\* The application fee is a handling fee for the Osaka YMCA and is used for processing and evaluation of each applicant.

(It is not the fee to apply for your visa.) The application fees are not refundable.

### 【Refund Policy】

#### ① Before the Enrollment Ceremony

- If the visa application is rejected, even though the proper application procedures were followed, the full amount including entrance, tuition and materials will be refunded.
- If you decline enrollment for personal reasons, tuition and fees (excluding the enrollment fee) will be refunded only if you notify us in writing of your decision to decline enrollment by the day before the entrance ceremony for each semester specified in the annual schedule.

#### ② After the Enrollment Ceremony

- If you are accepted to a Japanese university by the end of the course and your term at the university overlaps with our term, we will refund the remaining tuition fee.
- If you withdraw for personal reasons, we will deduct an administrative fee and refund the tuition fee for the unused period based on the following formula.

① Preparatory Japanese Course for Higher Education  $\{(total\ tuition\ fee\ for\ the\ semester - administrative\ fee\ 200,000JPY) \div number\ of\ weeks\ of\ classes\ in\ the\ semester\} \times number\ of\ weeks\ not\ attended = refund\ amount$

② Practical Japanese Course for Career Development  $\{(total\ tuition\ fee\ for\ 3\ months - administrative\ fee\ 100,000JPY) \div number\ of\ weeks\ of\ classes\ in\ the\ 3\ months\} \times number\ of\ weeks\ not\ attended = refund\ amount$

Bank fees incurred for refunds will be deducted in full.



## V. Other Features / Benefits

### Volunteer and Mutual Exchange

#### ★ Volunteer Tutor System

Weekly tutorials by Japanese volunteers offer enjoyable conversation practice and opportunities to interact with people. Students can freely talk about Japanese people, Japanese culture and their own country. They will be able to brush up their speaking skills in a friendly atmosphere.

#### ★ There are plenty of opportunities to interact with Japanese people.

By participating in volunteer programs organized by the Osaka YMCA and having close contact with people in elementary schools, junior high schools and high schools in the local community, students will have more opportunities to meet Japanese people and be able to expand their network.

### Support System

#### ★ Student 24- hour Mutual Insurance

All students can join the system at the Osaka YMCA. This system covers accidents and damage that take place in school life and daily life. It also prepares for situations such as environmental changes at home, whereby students are unable to continue to go to school.

※ It is applied to medical expenses in case of incidental injury, liability compensation for accidents caused by students in daily life, and death of students or their sponsors due to injury or illness. Support is available 24-hours a day both in Japan and overseas.

※ In the case of illness or injury, you will need to pay your own medical expenses. For this reason, those staying in Japan for 1 year or more need to join Japanese National Health Insurance Program. Those who come to Japan and enter school with a temporary visitor visa, please obtain travel insurance in your country.

#### ★ Reduction and Exemption system

We have an exemption system for the enrollment fee for those who have already passed the following tests at the time of enrollment.

- ① JLPT N2 or N1
- ② EJU(Examination for Japanese University Admission for International Students): Students with above 220 score, excluding the score of writing test. ※Only for those who apply for Preparatory Japanese Course for Higher Education.
- ③ J.TEST(Test of Practical Japanese) A-C level test: Above 600 score.
- ④ The Japanese Language NAT-TEST: Above Level 2.

※If you want to apply for the Reduction and exemption system, please tell us when you submit your Application form. You need to submit a certificate showing the test score above.

## University & Technical College

Osaka YMCA Gakuin can recommend admission to the following universities.

Kansai Gakuin University	Osaka University of Tourism	Kansai University of International Studies
Ryutsu Keizai University	St.Andrew's University	Kyoto University of Foreign Studies
Osaka Gakuin University	Osaka Jogakuin University	Seijoh University
Kobe Gakuin University	Otemon Gakuin University	Osaka University of Economics and Law

We can also recommend students for admission with privileges, such as waving of examination fees, to the **following technical colleges.**

- OSAKA SOGO COLLEGE OF DESIGN
- SYUSEI TECHNICAL COLLEGE
- OSAKA COLLEGE OF TOURISM & BUSINESS
- SUNDAI Osaka Business College of Hospitality & Foreign Languages
- Osaka YMCA International College / International Hotel Course & International Business Course

※ The above information vary from year to year.

## VI. Accommodation

R- 桃谷

R-Momodani

Close to the school, fully furnished and equipped Wifi.

Address	3-8-23 Katsuyamakita, Ikuno-ku, Osaka-City	
Commuting Time	Approximately 15 minutes (one way)	
Room Facilities	16 m <sup>2</sup> , Unit bath, Small kitchen, AC, Refrigerator, Microwave, Washing Machine, Vacuum cleaner, Curtain, etc.	
Shared Facilities	Elevator, Auto lock, Bicycle parking space	
Fees	Deposit	1 month rent fee (Refundable at the end of the contract)
	Rent	¥43,000 ~ 47,000 (Including maintenance fee, water bill, fire insurance fee, and rent guarantee)
	Others	Electricity fee : Own expense / Gas fee : Own expense

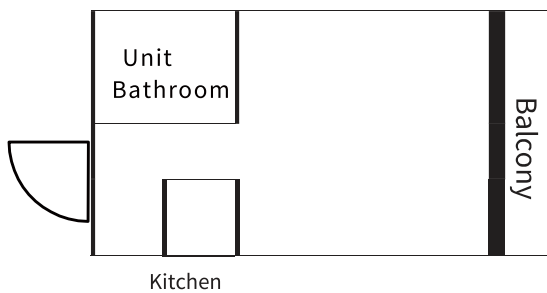

シャトー今里  
Chateau-IMAZATO

The room features a balcony and the Internet access.

Building name	Chateau Imazato I	Chateau Imazato II
Address	3-2-16, Shin Imazato, Ikuno-ku, Osaka-City	3-2-7, Shin Imazato, Ikuno-ku, Osaka-City
Commuting Time	Approximately 25 minutes (one way)	
Room Facilities	12 - 14 m <sup>2</sup> , Unit bathroom, Mini-kitchen, Air conditioner, Refrigerator, Washing machine	
Shared Facilities	Elevator not available	Elevator equipped
Fees	Deposit	¥ 0
	Rent	¥ 29,000 ~ 40,000 (Including maintenance fee, water and internet fee)
	Others	Electric fee : Own expense, Gas fee : Own expense, Fire insurance : 500 yen /month

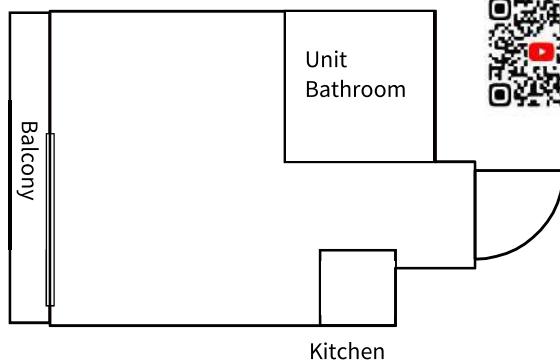

# Chateau-BISYOUEN

## シャトー美章園

The company has been in business for 50 years.

Providing economical prices and friendly service for international students.

Address	1-8-20, Kitatanabe, Higashi Sumiyoshi-ku, Osaka-City	
Commuting Time	Approximately 13 minutes (one way)	
Room Facilities	22.91~23.36 m <sup>2</sup> , AC, Refrigerator, Microwave, Washing Machine, Light, IH heater, desk, chair, bed, closet	
Shared Facilities	Free-wifi, Manager stationed, Elevator, Auto-lock Entrance, Bicycle Parking Lot	
Fees	Deposit	¥0
	Rent	¥46,000 (Including maintenance Fee and water bill)
	Others	Electric fee: Own expense, Gas fee: Own expense



We can introduce you to YMCA-recommended Accommodations upon request.

These are just some examples. We have many other properties available for recommendation as well.

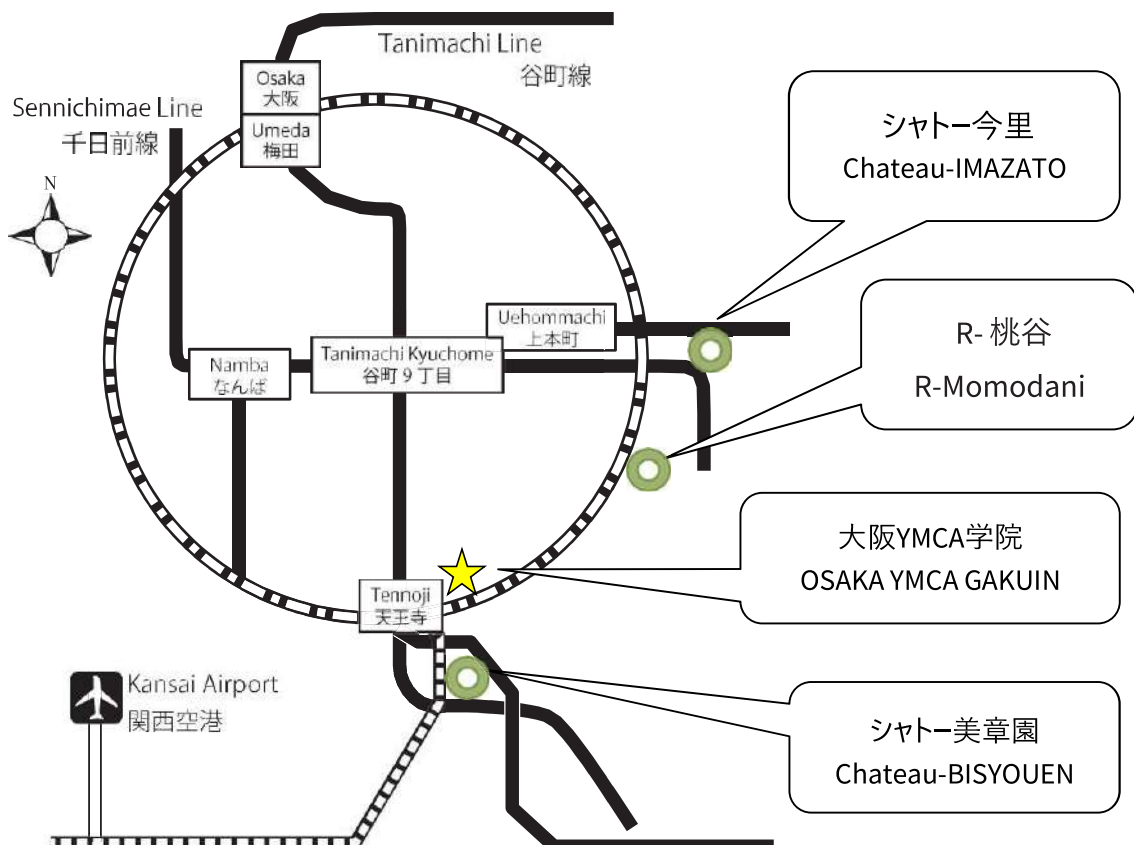



## Access to Osaka YMCA Gakuin

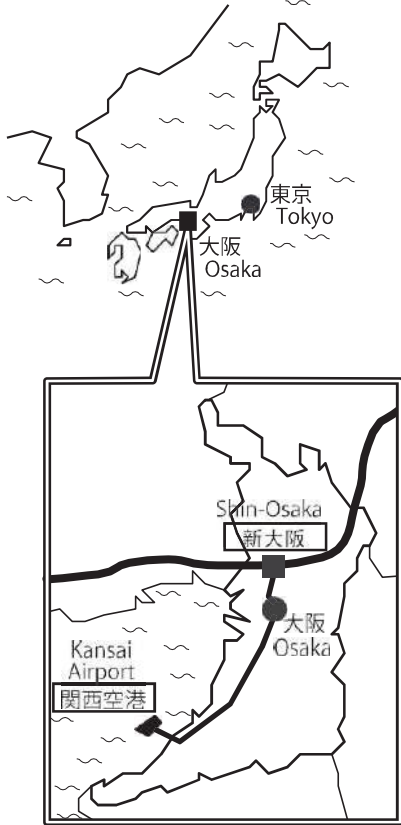

From Kansai International airport by JR

関西空港  
Kansai Airport

JR

45 mins

天王寺駅  
Tennoji Station

On foot

大阪YMCA学院 Osaka YMCA Gakuin

From Kansai International airport by bus

関西空港  
Kansai Airport

Limousine Bus

55 mins

あべのハルカス  
(天王寺駅)  
Abeno Harukas  
(Tennoji Station)

On foot

大阪YMCA学院 Osaka YMCA Gakuin

Tennoji Station / Abenobashi Station  
Tennoji Station: JR / Subway Tanimachi Line / Midosuji Line  
Osaka Abenobashi : Kintetsu Minami  
5 minutes east from the North Exit of Tennoji station

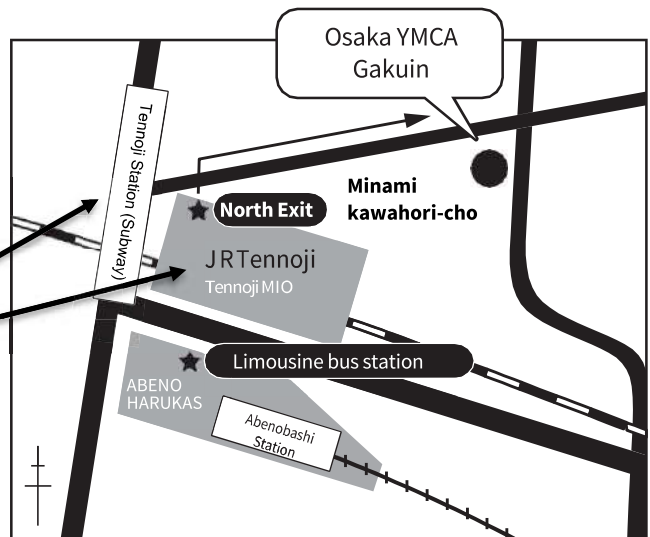

### 認定日本語教育機関 留学

Nationally Accredited Japanese language educational institutions for Study in Japan

Osaka YMCA Gakuin

<https://www.osakaymca.ac.jp/nihongo/>

9-52 Minami kawahori-cho, Tennoji-ku, Osaka-shi, Osaka 543-0054

Tel: 06-6779-8364 Fax: 06-6779-1833

E-mail: [info-jp@osakaymca.org](mailto:info-jp@osakaymca.org)

**Business Hours: Monday to Friday (Closed on Saturdays, Sundays and National Holidays)**

For Applying: 9:00 a.m. – 6:00 p.m. General Inquiries: 9:00 a.m. – 6:30 p.m.