

# Osaka YMCA Gakuin Japanese Language School & International College

## Student Dormitory Information

### Osaka YMCA Gakuin Japanese Language School (P.2~P.5)

- ① Chateau Imazato 1 / ② Chateau Imazato 2 / ③ Chateau Bisyoen
- ④ TSURUMIBASHI noie / ⑤ Chateau Daikoku 2 (3months only)
- ⑥ TOYAMASO / ⑦ Cityhomes Harinakano PT1
- ⑧ Habitation23 / ⑨ Estemar Tsuruhashi2 / ⑩ R-NAMBA SOUTH
- ⑪ R-Nishitanabecyou / ⑫ M-Yamasaka / ⑬ FC-Tezukayama
- ⑭ R-Momodani / ⑮ Teradacho Heights



### Osaka YMCA International College (P.6~P.10) Japanese Language School

- ⑯ Chateau Daikoku / ⑰ Chateau Daikoku 2
- ⑱ Chateau Kujo / ⑲ Chateau Kujo 2
- ⑳ Corpo Inn Nagai / ㉑ Corpo Tensho
- ㉒~㉖ LeaLea Kujo (51, 52, 53, 55, 56)
- ㉗~㉓ Lea Lea Midoribashi (23, 25, 26, 30)
- ㉔ ORI Daikokucho / ㉕ NA Kujo
- ㉖ V Shinosaka / ㉗ R-SEKIME

### Common dormitory in both schools (P. 11~12)

- ㉘~㉚ Chateau Hanazono (3, 4, 7)



- \* The nearest station, commuting hours, transportation fee in this booklet are calculated from each school.
- \* Information can be changed depending on the situation.

\*The nearest station, commuting hours, transportation fee in this brochure is calculated from each school.  
 \*Information can be changed depending on the situation.  
 \*According to the local ordinance of Osaka City, oversized garbage disposal fee is required when disposing of Futons (Futon / blanket (up to 4 sheets) 200 yen). Please be careful when moving out.

Osaka YMCA Gakuin			
	①Chateau Imazato1	②Chateau Imazato2	③Chateau Bishoen
	Male・Female		Male・Female
Location			
Address	3-2-16, Shin Imazato, Ikuno-ku, Osaka-city	3-2-7, Shin Imazato, Ikuno-ku, Osaka-city	1-8-20, Kitatanabe, Higashiumiyoshi-ku, Osaka-city
Nearest station	Kintetsu Nara line /Osaka line [Imazato]		JRHanwa line [Bishoen]
Commuting time	About 25minutes		About 13minutes
	Walk→ Kintetsu (train)→ JR loop line →Walk		Walk →JRHanwa line→Walk
Transportation fee	commuting ticket (3months) :26,240 yen commuting ticket (3months) :12,670 yen		commuting ticket (3months) :11,300yen commuting ticket (3months) : 6,590yen
	(Bicycle)	About 25minutes	About 11minutes
Fee			
Deposit etc	At the time of moving in :House cleaning fee ¥20,000		Deposit ¥40,000 (Non refundable) At the time of moving in :house cleaning fee20,000yen
Rent	¥29,000~39,000/month (Included :maintenance fee and water fee)		¥46,000/month <b>2LDK</b> (Included:maintenance and water fee)
Others	Electricity fee : Actual expenses Gas fee : Actual expenses Fire insurance ¥500/month		Electricity fee: Actual expenses Gas fee:Actual expenses Fire insurance fee ¥500/month
Initial cost on move in date	Rent at the current month (daily payment) + rent for next month Fire insurance ¥500 (not daily) House cleaning fee ¥20,000		Deposit ¥40,000 Rent at the current month (daily basis) + rent for next month Fire insurance ¥500 (not daily basis) House cleaning fee ¥20,000
Room, facility			
Room	12.15~13.74㎡		22.91~23.36㎡
Bath room	Unit bath		Unit bath
Mini kitchen	○		○
Internet	Free Wi-Fi is available at all rooms. (Available from the day of move in, Separate charge / penalty is not needed) ※Cable is available.		Free Wi-Fi is available at all rooms. (Available from the day of move in, Separate charge / penalty is not needed) ※Cable is available.
Others	Air conditioner, refrigerator, washing machine, lighting, IH cooking heater, desk, chair, folding bed, sectional closet (Futon: proxy purchase before moving in is possible for those who need...¥8,000/rental fee...¥6,000/3months) (Additional option of furniture- microwave, rice cooker ...¥10,000) Registration fee for bicycle parking area: ¥1,000 (first time only)		Airconditioner, refrigerator, washing machine, lightening, IH cookingheater, desk, chair, bed, sectional closet ((Futon: proxy purchase before moving in is possible for those who need...¥8,000) (Additional option of furniture- microwave, rice cooker ...¥10,000) Registration fee for bicycle parking area:¥1000 (only the first time)
Shared facilities			
	Janitor assigned	Elevator Janitor assigned	Elevator/ Entrance :self lock/ Coin laundry(washing machine, dryer-charged)/ Bicycle parking area/ Janitor assinged

### Terms of contract with temporary visitor visa

Chateau Imazato1	Chateau Imazato2	Chateau Bishoen
No	No	No

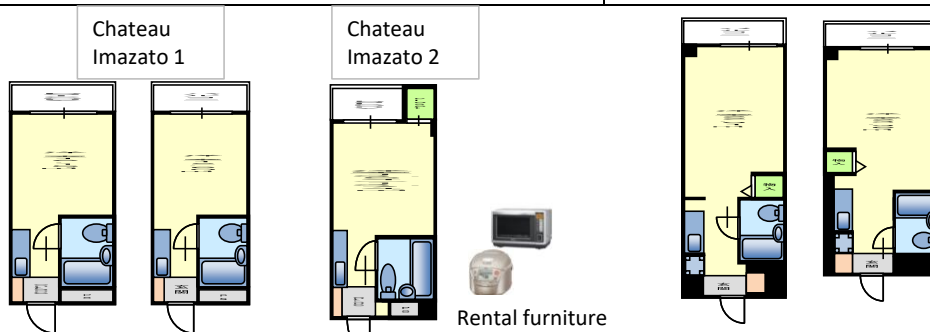

Rental furniture  
(Long term contract 2sets ¥10,000)

\*The nearest station, commuting hours, transportation fee in this brochure is calculated from each school.  
 \*Information can be changed depending on the situation.  
 \*According to the local ordinance of Osaka City, oversized garbage disposal fee is required when disposing of Futons (Futon / blanket (up to 4 sheets) 200 yen). Please be careful when moving out.

Osaka YMCA Gakuin		
	④TSURUMIBASHI noie (Share House)	⑤Chateau Daikoku 2
	Male • Female	Male • Female
Location		
Address	3-8-16, Tsurumibashi, Nishinari-ku, Osaka-city	3-7-9, Daikoku, Naniwa-ku, Osaka-city
Nearest station	Subway Yotsubashi line [Hanazonocho]	JR Yamatoji/loop line [Imamiya]
Commuting time	About 29minutes Walk→ Subway Yotsubashi line→ Midosuji line→Walk	About 10minutes Walk→JR loop line→ Walk
Transportation fee	commuting ticket (3months) :25,940 yen commuting ticket (3months) :11,970 yen	commuting ticket (3months) :11,300 yen commuting ticket (3months) :6,590 yen
(Bicycle)	About 20minutes	About 15minutes
Fee		
Deposit etc	Move in fee ¥20,000 (Non refundable)	Only 3month contract. Detail is written below.
Rent	¥29,000~32,000/month	
Others	Management fee: ¥13,200/month (Included: Water fee, Gas fee, Electricity fee, Internet fee) Fire insurance ¥500/month	
Initial cost on move in date	Move in fee ¥20,000 Rent at the current month (daily payment) + rent for next month Management fee at the current month (daily payment) + Management fee for next month Fire insurance ¥500 (not daily)	
Room, facility		
Room	7.17~9.63㎡	12.44~12.61㎡
Bath room	Share	Unit bath
Mini kitchen	Share	○
	Free Wi-Fi is available at all rooms. (Available from the day of move in, Separate charge / penalty is not needed) ※Cable is available.	Free Pocket Wi-Fi is available at all rooms. (Available from the day of move in, Separate charge / penalty is not needed) ※Cable LAN is also available.
Others	Air Conditioner, Refrigerator, Desk, Chair, Bed, Sectional Closet, Curtain (Futon: proxy purchase before moving in is possible for those who need...¥8,000)	Air conditioner, refrigerator, washing, lighting, IH cooking heater, desk, folding bed (Futon: proxy purchase before moving in is possible for those who need...¥8,000) Registration fee for bicycle parking area: ¥1,000 (first time only)
Shared facilities		
	CCTV, Shoebox, Washing Machine, Clothes Dryer Machine, Sink, Shower Room, Toilet, Microwave, Rice Cooker, IH Heater, TV, Dining Table	Elevator Janitor assigned

### Terms of contract with temporary visitor visa

TSURUMIBASHI noie (Share House)	Chateau Daikoku 2
¥155,880~164,880/ 3months (Futon rental fee ¥6,000/3months) Electricity fee, Gas fee, Water fee, Internet fee & House Cleaning Fee are included.	¥182,000/ 3months Electricity fee, Gas fee, Water fee, Internet fee & House Cleaning Fee are included.

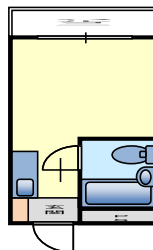
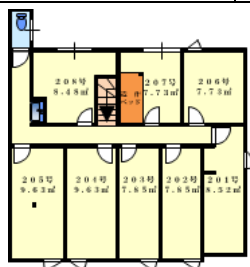
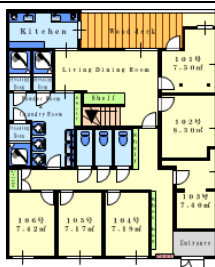

Rental furniture

(Short term contract: equipped with for free) 2

\*The nearest station, commuting hours, transportation fee in this brochure is calculated from each school.  
 \*Information can be changed depending on the situation.  
 \*According to the local ordinance of Osaka City, oversized garbage disposal fee is required when disposing of Futons (Futon / blanket (up to 4 sheets) 200 yen). Please be careful when moving out.

Osaka YMCA Gakuin			
	⑥TOYAMASO	⑦Cityhomes HarinakanoPT1	⑧Habitation23
	Male・Female	Male・Female / (1person)	Male・Female
Location			
Address	8-2-5, Sunji-yata, Higashi Sumiyoshi-ku, Osaka-city	1-15-36, Harinakano, Higashisumiyoshi-ku, Osaka city	2-1-50, Uriwari, Hirano-ku, Osaka-city
Nearest station	Kintetsu Osaka line [Yata]	Kintetsu Osaka line [Harinakano]	Subway Tanimachi line [Kireuriwari]
Commuting time	About 30 minutes walk → Kintetsu → subway → walk	About 17 minutes□ Walk→Kintetsu Osaka line→Walk	About 22minutes Walk→ Subway Tanimachi line→ Walk
Transportation fee	commuting ticket (3months) : 21,920yen commuting ticket (3months) : 10,350 yen	commuting ticket (3months) : 18,590yen commuting ticket (3months) : 8,500yen	commuting ticket (3months) : 25,940 yen commuting ticket (3months) : 11,970 yen
(Bicycle)	About 30 minutes	About 26 minutes	About 40minutes
Fee			
Deposit etc	Deposit ¥20,000 (Refundable at the time of moving out)	Deposit ¥20,000 (non refundable) At the time of moving in :House cleaning fee ¥20,000	Deposit ¥30,000~40,000(Non refundable) At the time of moving in :house cleaning fee ¥20,000
Rent	¥28,000/month (Included:internet, water and maintenance fee)	¥37,500~39,500/month (Included:maintenance, water fee)	¥45,000/month (Included :maintenance and water fee)
Others	Electricity fee is included into the rent (Maximum less than 50kw per month). If you use more, you have to defray the actual expenses.	Electricity fee : Actual expenses Gas fee : Actual expenses Fire insurance ¥500 (1month)	Electricity fee : Actual expenses Fire insurance ¥500/month
Initial cost on move in date	Deposit ¥20,000 Rent at the current month + rent for next month	Deposit ¥20,000 Rent at the current month (daily basis) + rent for next month Fire insurance ¥500 (not daily basis) House cleaning fee ¥20,000	Deposit ¥30,000~40,000 Rent at the current month (daily payment) + rent for next month Fire insurance ¥500 (not daily) House cleaning fee ¥20,000
Room, facility			
Room	10~13㎡ ( 6mat~8mat )	14.3㎡	17.32~17.36㎡
Bath room	Bath room only	Unit bath	○ (not Unit bath)
Mini kitchen	○	○	○
Internet	Available from the day of move in	Pocket Wi-Fi 100GB/month ¥4,400 / month You can apply before moving in. You have to use more than 1 month. ※¥3,300 is needed for first expense charge.	Free Wi-Fi is available at all rooms. (Available from the day of move in, Separate charge / penalty is not needed) ※Cable is available.
Others	Air conditioner, refrigerator, desk, chair, bed, futon, electric cooking stove	Air conditioner, refrigerator, electric cooking stove, lightning, washing machine, desk, chair, bed (Futon: proxy purchase before moving in is possible for those who need...¥8,000)	Air conditioner, refrigerator, washing machine, lighting, IH cooking heater, desk, chair, folding bed, sectional closet (Futon: proxy purchase before moving in is possible for those who need...¥8,000) ※all-electric house
Shared facilities			S
	washing machine, dryer, steam, vacuum cleaner, shower room, microwave	Free parking slot for bicycle (near place to apart)	Bicycle parking area

### Terms of contract with temporary visitor visa

TOYAMASO	Cityhomes HarinakanoPT1	Habitation23
No	No	No

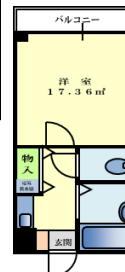
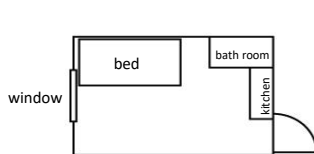

\*The nearest station, commuting hours, transportation fee in this brochure is calculated from each school.  
 \*Information can be changed depending on the situation.  
 \*According to the local ordinance of Osaka City, oversized garbage disposal fee is required when disposing of Futons (Futon / blanket (up to 4 sheets) 200 yen). Please be careful when moving out.

Osaka YMCA Gakuin			
	⑨Estemar Tsuruhashi2	⑩R-NAMBA SOUTH	⑪R-Nishitanabe
	Male • Female	Male • Female	Male • Female
Location			
Address	1-3-18, Tsuruhashi, Ikuno-ku, Osaka-city	1-7-14 Hanazonokita, Nishinari-ku, Osaka-city	2-6-21 Nishitanabecho, Abeno-ku, Osaka-city
Nearest station	Subway Sennichimae line, JR loop line Kintetsu line (Tsuruhashi)	JR Loop Line [Shin-Imamiya]	JR Hanwa Line [Tsurugaoka]
Commuting time	About 14 minutes	About 15 minutes	About 15 minutes
	Walk → JR loop line → Walk	Walk → JR loop line → Walk	Walk → JR loop line → Walk
Transportation fee	commuting ticket (3 months) : 11,300yen	General Commuter Pass (3ヶ月) : 11,090円	General Commuter Pass (3ヶ月) : 14,110円
	commuting ticket (3 months) : 6,590yen	Student Commuter Pass (3ヶ月) : 6,470円	Student Commuter Pass (3ヶ月) : 7,740円
(Bicycle)	About 11 minutes	About 20 minutes	About 25 minutes
Fee			
Deposit etc	Deposit 1 month rent fee (will be refunded at the time of moving out)	Deposit 1 month rent fee + RLS ¥2,000 (Refundable at the time of moving out)	
Rent	¥39,000~45,000 / month (Included: maintenance, water and Internet fee)	¥53,000 / month (Included: maintenance, water fee)	¥37,000~39,000 / month (Including: maintenance, water fee / electricity fee / gas fee)
Others	Electricity fee : Actual expenses Gas fee : Actual expenses Parking lot : ¥2,000 / month (applicants)	RLS: 2,000 yen / month (rent guarantee, fire insurance, 24-hour emergency response, withdrawal fee), basic cleaning fee: 22,000 yen (when moving out), electricity fee: actual cost, gas fee: actual cost	RLS: 2,000 yen / month (Rent guarantee, fire insurance, 24-hour emergency response, withdrawal fee) Basic cleaning fee: 22,000 yen (when moving out)
Initial cost on move in date	Deposit 1 month rent fee (will be refunded at the time of moving out) Rent of current month (daily payment) + rent for next month Fire insurance fee ¥13,000 (2 years)	deposit Dormitory fee: 50% of the deposit Previous rent: Current month (daily) rent + next month rent	
Room, facility			
Room	14.72㎡~16.56㎡	22㎡ (1K)	15~16㎡ (1R)
Bath room	Unit bath	Separate	Unit Bath
Mini kitchen	○		○
Internet	Free Wifi (40mb)	Free Wi-Fi is available at all rooms. (available from the day of move in, separate charge/penalty is not needed)	
Others	Air conditioner, refrigerator, closet, Electric cooking heater, bed, table, shoebox, curtain  Optional furnitures: Futon...¥8,000, rice cooker...¥6,000 or microwave+ rice cooker...¥10,000	Home appliances: 2-door refrigerator, microwave oven, vacuum cleaner, washing machine (without R Nishitanabe), air conditioner* Furniture: Beds, chairs, desks, closets, curtains, lighting  * R Nishitanabe does not have air conditioner heating, so a heater is installed. Options: Futon 8,000 yen, rice cooker 6000 yen	
Shared facilities			
	Elevator, Coin laundry (washing machine, drying machine- charged), Automatic lock entrance, Manager is stationed, Delivery box	Elevator, Auto lock, bicycle parking lot	Elevator, Auto lock, bicycle parking lot

### Terms of contract with temporary visitor visa

Estemar Tsuruhashi2	R-NAMBA SOUTH	R-Nishitanabe
No	Security deposit: 20,000 yen (refund when moving out) 3 months usage fee: 225,000 yen * Including futon, electricity, gas, water, internet, fire insurance, and basic cleaning fee	

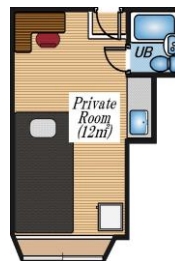

\*The nearest station, commuting hours, transportation fee in this brochure is calculated from each school.  
 \*Information can be changed depending on the situation.  
 \*According to the local ordinance of Osaka City, oversized garbage disposal fee is required when disposing of Futons (Futon / blanket (up to 4 sheets) 200 yen). Please be careful when moving out.

Osaka YMCA Gakuin				
	⑫M-Yamasaka	⑬FC-Tezukayama	⑭R-Momodani	⑮Teradacho Heights
	Male・Female	Male・Female	Male・Female	Male・Female
<b>Location</b>				
<b>Address</b>	2-11-6 Yamasaka, Higashiumiyoshi-ku, Osaka, Osaka	2-8-14 Bandai, Sumiyoshi-ku, Osaka, Osaka	3-8-23 Katsuyamakita, Ikuno-ku, Osaka, Osaka	1-18-21 Ikunonishi, Ikuno-ku, Osaka, Osaka
<b>Nearest station</b>	JR Hanwa Line Minamitanabe Sta.	Midousuji Line Nishitanabe Sta.	JR Osaka Loop Line Momodani Sta.	JR Osaka Loop Line Teradacho Sta.
<b>Commuting time</b>	About 11mins Walk→JR→Walk	About 20 mins Walk→Subway→Walk	About 16 mins Walk→JR→Walk	About 10 mins Walk 10 mins
<b>Transportation fee</b>	General Commuter Pass (3ヶ月): 11,300円 Student Commuter Pass (3ヶ月): 6,590円	General Commuter Pass (3ヶ月): 25,940円 Student Commuter Pass (3ヶ月): 11,970円	General Commuter Pass (3ヶ月): 11,300円 Student Commuter Pass (3ヶ月): 6,590円	General Commuter Pass (3ヶ月): 11,300円 Student Commuter Pass (3ヶ月): 6,590円
<b>(Bicycle)</b>	About 20 mins	About 22 mins	About 12 mins	About 5 mins
<b>Fee</b>	2 Persons available			
<b>Deposit etc</b>	Deposit 1month rent fee + RLS¥2,000 (Refundable at the time of moving out)			
<b>Rent</b>	¥38,000~42,000 /month	¥38,000/month	¥38,000~43,000 /month	¥68,000~73,000 /month
	(Include: Maintenance Fee, Water Bill, Free Internet)			
<b>Others</b>	RLS: ¥2,000 (RLS=Rent guarantee, Fire insurance, 24 hour emergency support, transfer fee) Electricity fee: Actual expenses Gas fee: Actual expenses			
<b>Initial cost on move in date</b>	deposit Dormitory fee: 50% of the deposit Previous rent: Current month (daily) rent + next month rent			
<b>Room, facility</b>				
<b>Room</b>	20㎡ (1K)	15㎡ (1R)	16㎡ (1R)	28㎡ (2K・1LDK)
<b>Bath room</b>	Unit Bath	Unit Bath	Unit Bath	Separate
<b>Mini kitchen</b>	○	○	○	○
	Free Wi-Fi is available at all rooms. (available from the day of move in, separate charge/penalty is not needed)			
<b>Others</b>	Home appliances: 2-door refrigerator, microwave oven, vacuum cleaner, washing machine, air conditioner* Furniture: Beds, chairs, desks, closets, curtains, lighting * M Yamasaka does not have air conditioner heating, so a heater is installed. Options: Futon 8,000 yen, rice cooker 6000 yen			
<b>Shared facilities</b>				
	Stairs, Bicycle parking space	Stairs, Bicycle parking space	Elevator, Auto lock, Bicycle parking space	Auto lock, Stairs, Bicycle parking space

### Terms of contract with temporary visitor visa

M-Yamasaka	FC-Tezukayama	R-Momodani	Teradacho Heights
Deposit: 20,000 yen (refund when moving out) 3 months usage fee: 225,000 yen * Includes futon, electricity, gas, water, internet, fire insurance, and basic cleaning			No
Futon Set (New : ¥8,000) /Ricecooker(New : ¥6,000)			



\*The nearest station, commuting hours, transportation fee in this brochure is calculated from each school.  
 \*Information can be changed depending on the situation.  
 \*According to the local ordinance of Osaka City, oversized garbage disposal fee is required when disposing of Futons (Futon / blanket (up to 4 sheets) 200 yen). Please be careful when moving out.

**Osaka YMCA Gakuin**

	⑯Chateau Daikoku	⑰Chateau Daikoku2	⑱Chateau Kujo	⑲Chateau Kujo2
	Male · Female	Male · Female	Male · Female	Male · Female
<b>Location</b>				
Address	3-10-7, Daikoku, Naniwa-ku, Osaka-city	3-7-9, Daikoku, Naniwa-ku, Osaka-city	1-16-9, Kujo, Nishi-ku, Osaka-city	1-12-24, Kujo, Nishi-ku, Osaka-city
Nearest station	Osaka-city bus [Kujo Shinmichi]			
Commuting time	Subway (about 20minutes) walk → subway → walk		Bus (about 15minutes) walk → bus → walk	
Transportation fee	commutation ticket for student (3months) : ¥11,970 commutation ticket for student (6months) : ¥22,680		commutation ticket for student (3months) : ¥14,710 commutation ticket for student (6months) : ¥27,860	
(Bicycle)	Not be able to go to school by bicycle		About 15minutes	
<b>Fee</b>				
Deposit etc	Deposit (non refundable) brighter room :¥30,000 darker room :¥20,000 House cleaning fee ¥20,000			
Rent	¥36,000~48,000/month (Included: maintenance and water fee)		¥36,000~43,000/month (Included: maintenance and water fee)	
Others	Electricity fee : Actual expenses Gas fee : Actual expenses Fire insurance : ¥500 (1month)			
Initial cost on move in date	Deposit ¥20,000~¥30,000 Rent at the current month (daily payment) + rent for next month Fire insurance ¥500 /month (not daily) Cleaning fee ¥20,000			
<b>Room, facility</b>				
Room	12.15~16.75㎡□		12.6~13.43㎡	
Bath room	Unit Bath			
Mini kitchen	○			
Internet	Free Wi-Fi is available at all rooms. (Available from the day of move in, Separate charge / penalty is not needed) ※Cable is available.			
Others	Air conditioner, refrigerator, washing machine, lighting, IH cooking heater, desk, chair, folding bed, closet-hanger (Futon: proxy purchase before moving in is possible for those who need··¥8,000) (Additional option of furniture- microwave, rice cooker ···¥10,000) Registration fee for bicycle parking area: ¥1,000 (first time only)			
<b>Shared facilities</b>				
	Elevator/ Janitor assigned/Entrance:self lock	Elevator/ Janitor assigned		

**Terms of contract with temporary visitor visa**

Chateau Daikoku	Chateau Daikoku2	Chateau Kujo	Chateau Kujo2
No			

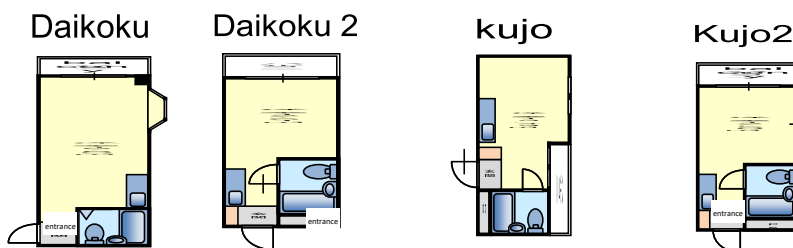

\*The nearest station, communitng hours, transportation fee in this brochure is calculated from each school.  
 \*Information can be changed depending on the situation.  
 \*According to the local ordinance of Osaka City, oversized garbage disposal fee is required when disposing of Futons (Futon / blanket (up to 4 sheets) 200 yen). Please be careful when moving out.

Osaka YMCA International college		
	②Corpo Inn Nagai	②Corpo Tensho
	Male • Female	Male • Female
<b>Location</b>		
Address	1-12-28, Nagai Nishi, Sumiyoshi-ku, Osaka-city	3-2-13, Nagai, Sumiyoshi-ku, Osaka-city
Nearest station	Subway Midosuji line [Nagai]	
Commuting time	About 45minutes walk → subway → walk	
Transportation fee	commutation ticket for student (3months) : ¥13,910 commutation ticket for student (6months) : ¥26,360	
(Bicycle)	Not be able to go to school by bicycle	
<b>Fee</b>		
Deposit etc	Deposit ¥20,000 (Refundable when moving out)	
Rent	¥35,000~45,000 (Included: maintenance and water fee)	
Others	Electricity fee : Actual expenses Gas fee : Actual expenses	
Initial cost on move in date	Deposit ¥20,000 Fire insurance ¥13,000(1 year) Rent at the current month(not daily)	
<b>Room, facility</b>		
Room	About 17~26㎡	About 16㎡
Bath room	○ (not together with a bathtub)	Unit Bath
Mini kitchen	○	
Internet	¥1,000/month (optical communication) Available from the day of move in. (Application in advance is necessary.)	
Others	Air conditoner, lights, closet, bed, refrigerator, microwave, desk, chair, rice cooker, electric cooking stove	
<b>Shared facilities</b>		
	Washing machine	

### Terms of contract with temporary visitor visa

Corpo Inn Nagai	Corpo Tensho
No	No



\*The nearest station, commuting hours, transportation fee in this brochure is calculated from each school.  
 \*Information can be changed depending on the situation.  
 \*According to the local ordinance of Osaka City, oversized garbage disposal fee is required when disposing of Futons (Futon / blanket (up to 4 sheets) 200 yen). Please be careful when moving out.

Osaka YMCA International college					
	㉒LeaLea Kujo51	㉓LeaLeaKujo52	㉔LeaLea Kujo53	㉕LeaLea Kujo55	㉖LeaLea Kujo56
	Male ・ Female				
Location					
Address	3-30-10, Kujo Minami, Nishi-ku, Osaka-city	3-2-16, Honden, Nishi-ku, Osaka-City	2-7-14 Honden, Nishi-ku, Osaka-City	1-2-19, Kujo Minami, Nishi-ku, Osaka-city	1-3-16, Kujo Minami, Nishi-ku, Osaka-city
Nearest station	Osaka-city bus [Sakaigawa]	Osaka-city bus [Honden 1chome]		Osaka-city bus [Hanshin Kujo]	Osaka-city bus [Hanshin Kujo]
Commuting time	About 15minutes walk → bus → walk				
Transportation fee	commutation ticket for student (3months) : ¥14,710 commutation ticket for student (6months) : ¥27,860				
(Bicycle)	About 20minutes				
Fee					
Deposit etc	Deposit ¥50,000 (non refundable) Guarantee fee ¥20,000 (non refundable)				
Rent	¥34,000~36,000				
Others	Maintenance fee : ¥7,000 / month      Water fee : ¥2,500 / month Electricity fee : Actual expenses      Gas fee : Actual expenses				
Initial cost on move in date	Deposit ¥50,000    Guarantee Fee ¥20,000 Rent at the current month (daily payment) + rent for next month Fire insurance ¥10,000 (2years) Cleaning fee ¥16,500    Neighborhood association fee ¥3,600				
Room, facility					
Room	About 15㎡				
Bath room	Unit Bath				
Mini kitchen	○				
Internet	¥2,700/month (optical communication) , Application needs to be done by oneself and it will take 1-2weeks to get through.				
Others	Air conditioner, refrigerator, bed, closet, lighting (Futon : proxy purchase before moving in is possible for those who need...¥6,200)				
Shared facilities					
	Automatic lock entrance, Elevator Coin laundry	Automatic lock entrance, Elevator Coin laundry	Automatic lock entrance, Elevator	Automatic lock entrance, Elevator Coin laundry	Automatic lock entrance, Elevator Coin laundry

Terms of contact with temporary visitor visa (3month)

LeaLea Kujo51	LeaLeaKujo52	LeaLea Kujo53	LeaLea Kujo55	LeaLea Kujo56
No	No	No	No	No

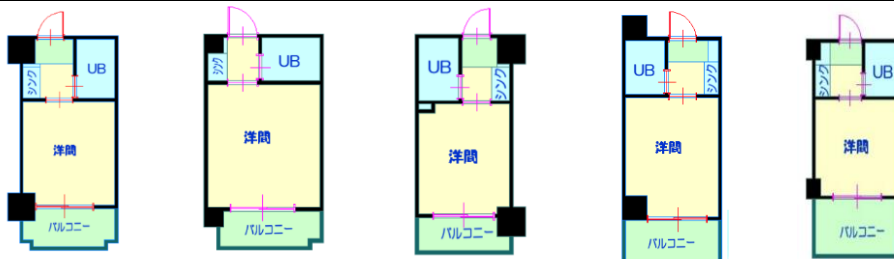

\*The nearest station, commuting hours, transportation fee in this brochure is calculated from each school.  
 \*Information can be changed depending on the situation.  
 \*According to the local ordinance of Osaka City, oversized garbage disposal fee is required when disposing of Futons (Futon / blanket (up to 4 sheets) 200 yen). Please be careful when moving out.

**Osaka YMCA International college**

①LeaLea Midoribashi 23
②LeaLea Midoribashi 25
③LeaLea Midoribashi 26
④LeaLea Midoribashi 30

Male · Female

<b>Location</b>				
Address	3-10-2, Higashinakahama, Jyoto-ku, Osaka-City	6-15-10, Higashinakahama, Jyoto-ku, Osaka-City	9-3-32, Higashinakahama, Jyoto-ku, Osaka-City	2-3-18, Nakamoto, Higashinari-ku, Osaka-City
Nearest station	Subway Chuo line [Midoribashi]			
Commuting time	About 40 minutes walk → subway Chuo line → subway Yotsubashi line → walk			
Transportation fee	commutation ticket for student (3months) : 11,970円 commutation ticket for student (6months) : 22,680円			
(Bicycle)	Not be able to go to school by bicycle			
<b>Fee</b>				
Deposit etc	Deposit ¥50,000 (non refundable) Guarantee fee ¥20,000 (non refundable)			
Rent	¥28,000~¥32,000			
Others	Maintenance fee : ¥7,000 / month      Water fee : ¥2,500 / month Electricity fee : Actual expenses      Gas fee : Actual expenses			
Initial cost on move in date	Deposit ¥50,000    Guarantee Fee ¥20,000 Rent at the current month (daily payment) + rent for next month Fire insurance ¥10,000 (2years) Cleaning fee ¥16,500    Neighborhood association fee ¥3,600			
<b>Room, facility</b>				
Room	約15㎡			
Bath room	Unit Bath			
Mini kitchen	○			
Internet	¥2,700/month (optical communication) , Application needs to be done by oneself and it will take 1-2weeks to get through.			
Others	Air conditioner, refrigerator, bed, closet, lighting (Futon : proxy purchase before moving in is possible for those who need...¥6,200)			
<b>Shared facilities</b>				
	Automatic lock entrance, Elevator, Coin laundry			

**Terms of contact with temporary visitor visa (3month)**

LeaLea Midoribashi 23	LeaLea Midoribashi 25	LeaLea Midoribashi 26	LeaLea Midoribashi 30
No	No	No	No

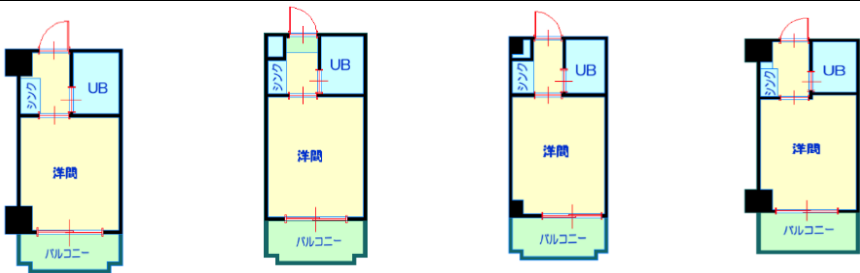

\*The nearest station, commuting hours, transportation fee in this brochure is calculated from each school.  
 \*Information can be changed depending on the situation.  
 \*According to the local ordinance of Osaka City, oversized garbage disposal fee is required when disposing of Futons (Futon / blanket (up to 4 sheets) 200 yen). Please be careful when moving out.

Osaka YMCA International College				
	㉑R-Namba West	㉒NA Kujo	㉓V Shinosaka	㉔R-SEKIME
Male • Female				
Location				
Address	4-14 Ebisuonmachi, Naniwa-ku, Osaka	2-1-10 Kujo, Nishi-ku, Osaka	2-15-2 Higashinakajima	3-9-20 Sekime, Joto-ku, Osaka
Nearest station	Daikokucho Station	Kujo Station	Nakajima Minamikata S	Sekime Station
Commuting time	About 20 minutes	About 20 minutes	About 30 minutes	About 31 minutes
	Walk → Subway → Walk	Walk → Subway → Walk	Walk → Subway → Walk	Walk → Train → Walk
Transportation fee	Commuter Pass(3months) ¥ 11,970	Commuter Pass(3months) ¥ 11,970	Commuter Pass(3months) ¥ 11,970	Commuter Pass(3months) ¥ 10,150
	Commuter Pass(6months) ¥ 22,680	Commuter Pass(6months) ¥ 18,530	Commuter Pass(6months) ¥ 22,680	Commuter Pass(6months) ¥ 19,230
(Bicycle)	About 30 minutes	About 15 minutes	About 30 minutes	About 30 minutes
Fee				
Deposit etc	Deposit 1month rent fee(Refundable at the time of moving out)			
Rent	¥56,000~73,000	¥50,000	¥38,000~46,000	¥33,000~42,000
(Included: maintenance, water fee, Internet)				
Others	RLS: 2,000 yen / month (rent guarantee, fire insurance, 24-hour emergency response, withdrawal fee), basic cleaning fee: 22,000 yen (when moving out), electricity fee: actual cost, gas fee: actual cost			
Initial cost on move in date	Deposit 1month rent fee(Refundable at the time of moving out) Dormitory fee: 50% of the deposit Previous rent: Current month (daily) rent + next month rent			
Room, facility				
Room	22~31㎡	18㎡	15~18㎡	15~20㎡
Bath room	Separate	Unit bath		
Mini kitchen	○			
Internet	Free WiFi is available at all rooms. Available from the day of move in. No additional fee nor penalty fee.			
Others	Elevator Entrance at the building - self lock Other(New):Futon ¥8,000, Ricecooker ¥6,000, Name stamp set ¥2,000 (Stamp + Stamp Case)			
Shared facilities				
Elevator, bicycle parking lot	Air conditioner, refrigerator, microwave, Vacuum cleaner, washing machine, bed, chair, desk, closet hangers, curtain, lightning	Air conditioner, refrigerator, microwave, Vacuum cleaner, washing machine, bed, chair, desk, closet hangers, curtain, lightning, sharing coin laundry	Automatic door lock, stairs, Bicycle parking lot (limited on the number of vehicles)	

### Terms of contact with temporary visitor visa (3month)





R-Namba West	NA Kujo	V Shinosaka	MD Shinosaka
Deposit: 20,000 yen (refund when moving out) 3 months usage fee: 225,000 yen * Includes futon, electricity, gas, water, internet, fire insurance, and basic cleaning			

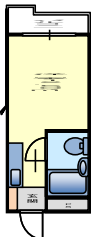
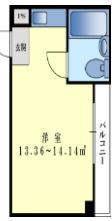

\*The nearest station, commuting hours, transportation fee in this brochure is calculated from each school.  
 \*Information can be changed depending on the situation.  
 \*According to the local ordinance of Osaka City, oversized garbage disposal fee is required when disposing of Futons (Futon / blanket (up to 4 sheets) 200 yen). Please be careful when moving out.

Osaka YMCA Gakuin /Osaka YMCA International college						
Common	㊸Chateau Hanazono 3		㊹Chateau Hanazono 4		㊺Chateau Hanazono7	
	Male・Female		Male・Female / (1people)		Male・Female / (2person)	
Location						
Address	2-5-3, Hanazono kita, Nishi-ku, Osaka-city		1-10-10, Asahi, Nishi-ku, Osaka-city		1-6-21, Tsurumibashi, Nishi-ku, Osaka-city	
Nearest station	Subway Yotsubashi line [Hanazonocho]					
Commuting time	To Osaka YMCA Gakuin:About 20minutes Walk → Subway Yotsubashi iine → Subway Midosuji line → Walk					
Transportation fee	commuting ticket (3months) :25,940yen commuting ticket (3months) :11,970yen					
(Bicycle)	To Osaka YMCA Gakuin:About 17 minutes/ To Osaka YMCA International college: Not be able to go to school by bicycle					
Fee					Per 1person	
Deposit etc	Deposit¥10,000(Non refundable) At the time of moving in :house cleaning fee¥20,000				Deposit¥25,000(Non refundable) At the time of moving in :house cleaning fee ¥12,500	
Rent	¥31,000~38,000yen/month (Included:maintenance and water fee)	¥33,000~38,000yen/month (Included:maintenance and water fee)	①¥32,000~37,000yen/month (Included:maintenance and water fee) ②¥44,000~45,000/month (Included:maintenance and water fee)		¥28,000~30,000yen/month (Included:maintenance and water fee)	
Others	Electricity fee: Actual expenses Gas fee:Actual expenses Fire insurance fee ¥500/month				Electricity fee: Actual expenses Gas fee:Actual expenses Fire insurance fee ¥250/month	
Initial cost on move in date	Deposit¥ 10,000 Rent at the current month (daily basis) +rent for next month Fire insurance fee ¥500 (Not daily basis) House cleaning fee ¥20,000				Deposit ¥25,000 Rent at the current month (daily basis)+ rent for next month Fire insurance fee ¥250 (Not daily basis) house cleaning fee ¥12,500	
Room, facility						
Room	11.52~12.50㎡	13.36~14.79㎡	①1R 12.47~14.21㎡②1K 18.60~19.90㎡		2K 31.82~37.41㎡	
Bath room	Unit bath					
Mini kitchen	○					
Internet	Free Wi-Fi is available at all rooms (Available from the day of move in, No additional fee nor penalty fee) ※ Cable is available					
Others	Air conditoner, regrigerator, washing machine, lightning, IH cooking heater, desk, char, bed, wardrobe (futon: proxy purchase before moving in is availalbe...7,000yen) (Additional option of furniture-microwave, rice kooker:10,000yen) Registration fee for bicycle parking area:1000yen (only first time)				Air conditioner×2, refrigerator, washing machine, lightning, IH cooking heater, bed×2, desk×2, chair×2, wardrobe×2 (futon: proxy purchase before moving in is availalbe...8,000yen) (Additional option of furniture-microwave, rice kooker: 10,000yen)	
Shared facilities						
	Elevator / Bicycle parking area 1,000yen(first time only)/ Janitor assigned					

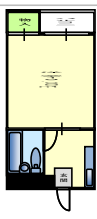
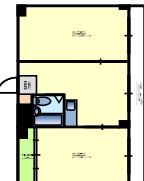
### Terms of contract with temporary visitor visa

Chateau Hanazono 3	Chateau Hanazono 4	Chateau Hanazono7		
¥159,500 / 3months Electricity, gas, water, internet fee are included.		No		
		1 R	1 K 19.90㎡	2 K 37.41㎡
				
 <p>Rental furniture Long term contract 2sets ¥10,000 Short term contract:free</p>				