

Osaka YMCA Japanese Language School

Student Dormitory Information

(P.2~P.5)

- ① Chateau Imazato 1 / ② Chateau Imazato 2 /
- ③ Chateau Bisyoen
- ④ TSURUMIBASHI NOIE / ⑤ Chateau Kyobashi Aruto /
- ⑥ Chateau Kyobashi Rarugo / ⑦ Cycle yard Osaka /
- ⑧ Chateau Astina Koraibashi / ⑨ La Parte /
- ⑩ Estemar Tsuruhashi2 / ⑪ R-Momodani /
- ⑫ R-NAMBA SOUTH / ⑬ FC-Tezukayama / ⑭ M-Yamasaka /
- ⑮ Teradacho Heights / ⑯ R-NAKANO /



(P.6~P.8)

- ⑰ Chateau Daikoku / ⑱ Chateau Daikoku 2
- ⑲ Chateau Kujo / ⑳ Chateau Kujo 2
- ㉑ ORI Daikokucho / ㉒ NA Kujo
- ㉓ V Shinosaka / ㉔ R-SEKIME
- ㉕ ~ ㉗ Chateau Hanazono (3, 4, 7)



* The nearest station, commuting hours, transportation fee in this booklet are calculated from school.

* Information can be changed depending on the situation.

*The nearest station, commuting hours, transportation fee in this brochure is calculated from each school.
 *Information can be changed depending on the situation.
 *According to the local ordinance of Osaka City, oversized garbage disposal fee is required when disposing of Futons (Futon / blanket (up to 4 sheets) 200 yen). Please be careful when moving out.

	①Chateau Imazato1	②Chateau Imazato2	③Chateau Bishoen
	Male・Female		Male・Female
Location			
Address	3-2-16, Shin Imazato, Ikuno-ku, Osaka-city	3-2-7, Shin Imazato, Ikuno-ku, Osaka-city	1-8-20, Kitatanabe, Higashiumiyoshi-ku, Osaka-city
Nearest station	Kintetsu Nara line /Osaka line [Imazato]		JRHanwa line [Bishoen]
Commuting time	About 25minutes Walk→ Kintetsu (train)→ JR loop line →Walk		About 13minutes Walk →JRHanwa line→Walk
Transportation fee	commuting ticket (3months) :29,870 yen commuting ticket for students(3months) :13,240 yen		commuting ticket (3months) :12,200yen commuting ticket for students (3months) : 6,590yen
(Bicycle)	About 25minutes		About 11minutes
Fee			
Deposit etc	Deposit ¥0 At the time of moving in :house cleaning fee ¥25,000		Deposit ¥0 At the time of moving in :house cleaning fee ¥25,000
Rent	¥31,000~37,000/month (Included :maintenance fee and water fee)		¥46,000/month (Included :maintenance and water fee)
Others	Electricity fee : Actual expenses Gas fee : Actual expenses Fire insurance ¥500/month		Electricity fee: Actual expenses Gas fee:Actual expenses Fire insurance fee ¥500/month
Initial cost on move in date	Deposit ¥0 Rent at the current month (daily payment) + rent for next month Fire insurance ¥500 (not daily) House cleaning fee ¥25,000		Deposit ¥0 Rent at the current month (daily payment) + rent for next month Fire insurance ¥500 (not daily) House cleaning fee ¥25,000
Room, facility			
Room	12.15~13.74㎡		22.91~23.36㎡
Bath room	Unit bath		Unit bath
Mini kitchen	○		○
Internet	Free Wi-Fi is available at all rooms. (Available from the day of move in, Separate charge / penalty is not needed) ※Cable is available.		Free Wi-Fi is available at all rooms. (Available from the day of move in, Separate charge / penalty is not needed) ※Cable is available.
Others	Air conditioner, refrigerator, washing machine, lighting, IH cooking heater, desk, chair, folding bed, sectional closet (Futon: proxy purchase before moving in is possible for those who need...¥8,500/rental fee...¥6,000/3months) (Additional option of furniture- microwave, rice cooker ...¥10,000) Registration fee for bicycle parking area: ¥1,000 (first time only)		Airconditioner, refrigerator, washing machine, lightening, IH cookingheater, desk, chair, bed, sectional closet ((Futon: proxy purchase before moving in is possible for those who need...¥8,500) (Additional option of furniture- microwave, rice cooker ...¥10,000) Registration fee for bicycle parking area: ¥1000 (only the first time)
Shared facilities			
	Resident manager, Bicycle parking lot (prior application required) *5stories, stairs only, no elevator	Elevator/ Bicycle parking area (prior application required)/ Janitor assigned	Elevator/ Entrance :self lock/ Bicycle parking area (prior application required)/ Janitor assigned

Terms of contract with temporary visitor visa

Chateau Imazato1	Chateau Imazato2	Chateau Bishoen
¥155,880 ~ 164,880/ 3months Electricity fee, Gas fee, Water fee, Internet fee are included. *The contract ends on the 25th for the final month.		No

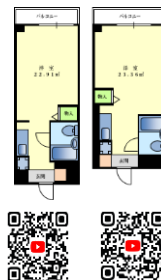
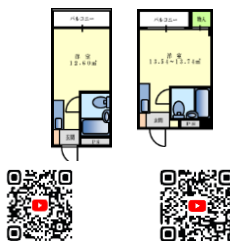

Rental furniture
(Long term contract 2sets \10,000)

*The nearest station, commuting hours, transportation fee in this brochure is calculated from each school.
 *Information can be changed depending on the situation.
 *According to the local ordinance of Osaka City, oversized garbage disposal fee is required when disposing of Futons (Futon / blanket (up to 4 sheets) 200 yen). Please be careful when moving out.

	④TSURUMIBASHI noie (Share House)	⑤Chateau Kyobashi Aruto	⑥Chateau Kyobashi Rarugo	⑦Cycle Yard Osaka (share house)
	Male • Female	Male • Female	Male • Female	Male • Female
Location				
Address	3-8-16, Tsurumibashi, Nishinari-ku, Osaka-city	1-12-16 Higashinodamachi, Miyakojima-ku, Osaka City	1-12-17 Higashinodamachi, Miyakojima-ku, Osaka City	1-19-20 sunjyata Higashisumiyoshi-ku Osaka
Nearest station	Subway Yotsubashi line [Hanazonocho]	JR Kyobashi Station		Kintetsu Minami Osaka line [Yata]
Commuting time	About 29minutes Walk→ Subway Yotsubashi line→ Midosuji line→Walk	About 10minutes Walk→JR loop line→ Walk		About 20 minutes walk → Kintetsu →walk
Transportation fee	commuting ticket (3months) :27,020 yen commuting ticket for students (3months) :11,970 yen	commuting ticket (3months) : 15,94 yen commuting ticket for students(3months) : 10,410yen		commuting ticket (3months) : 21,920yen commuting ticket for students (3months) : 10,350 yen
(Bicycle)	About 20minutes	About 30minutes		About 30 minutes
Fee				
Deposit etc	Move in fee ¥20,000 (Non refundable)	Deposit ¥70,500~87,500 At the time of moving in :house cleaning fee ¥25,000		Deposit ¥20,000 (Refundable at the time of moving out)
Rent	¥29,000~32,000/month	¥70,500~87,500/month		¥38,000/month (Exclusive discount for YMCA students) (Included:maintenance, electricity, gas, water fee)
Others	Management fee: ¥13,200/month (Included: Water fee, Gas fee, Electricity fee, Internet fee) Fire insurance ¥500/month	Electricity fee: Actual expenses Gas fee:Actual expense Fire insurance fee ¥500/month		Rent is paid monthly from the contract start date, calculated on a daily basis when you move out. Electricity fee : Actual expenses
Initial cost on move in date	Move in fee ¥20,000 Rent at the current month (daily payment) + rent for next month Management fee at the current month (daily payment) + Management fee for next month Fire insurance ¥500(not daily)	Deposit ¥70,500~87,500 Rent at the current month (daily payment) + rent for next month Fire insurance ¥500(not daily) House cleaning fee ¥25,000		Deposit 20,000 yen + Monthly rent + bicycle parking fee 1,000 yen Minimum contract period is 1 month
Room, facility				
Room	7.17~9.63㎡	23.70~25.39㎡	23.41~33.91㎡	10㎡ (6mat)
Bath room	Share	Separate		Bath room only
Mini kitchen	Share	○		○
	Free Wi-Fi is available at all rooms. (Available from the day of move in, Separate charge / penalty is not needed) ※Cable is available.	Free Pocket Wi-Fi is available at all rooms. (Available from the day of move in, Separate charge / penalty is not needed) ※Cable LAN is also available.		Free Wifi available(Available from the day you move in)
Others	Air Conditioner, Refrigerator, Desk, Chair, Bed, Sectional Closet, Curtain (Futon: proxy purchase before moving in is possible for those who need...¥8,000)	Air conditioner, shoe rack, IH stove, bathroom dryer, washstand, toilet seat with cleaning function, lighting, refrigerator, washing machine, bed, desk, chair, curtains *Additional furniture P L A N Rent +1,000 yen Microwave oven, rice cooker Rent + 3,000 yen TV, TV stand Rent + 4,000 yen Microwave oven, rice cooker, TV, TV stand		air conditioner, refrigerator, desk, chair, bed, clothes case
Shared facilities				
	CCTV, Shoebox, Washing Machine, Clothes Dryer Machine, Sink, Shower Room, Toilet, Microwave, Rice Cooker, IH Heater, TV, Dining Table	Auto lock/Security camera Elevator/Delivery box Bicycle parking lot registration fee: 1000 yen (first time only) *The number of bicycle parking spaces is limited.		kitchen (IH 6pcs) ,microwave, toaster

Terms of contract with temporary visitor visa

TSURUMIBASHI noie (Share House)	Chateau Kyobashi Aruto	Chateau Kyobashi Rarugo	Cycle Yard Osaka
¥155,880~164,880/ 3months (Futon rental fee ¥6,000/3months) Electricity fee, Gas fee, Water fee, Internet fee & House Cleaning Fee are included.	No	No	Deposit ¥20,000 Rent at the current month (daily basis) + Bicycle parking fee ¥1000 Shortest contract period 1month

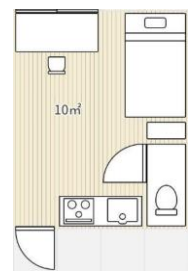

*The nearest station, commuting hours, transportation fee in this brochure is calculated from each school.

*Information can be changed depending on the situation.

*According to the local ordinance of Osaka City, oversized garbage disposal fee is required when disposing of Futons (Futon / blanket (up to 4 sheets) 200 yen). Please be careful when moving out.

	⑧Chateau Astina Koraibashi	⑨La Parte	⑩Estemar Tsuruhashi2
	Male・Female	Male・Female	Male・Female
Location			
Address	1-7 Higashi Koraibashi, Chuo Ward, Osaka City	1-9-21, Minamisenba, Chuo-ku, Osaka-city	1-3-18, Tsuruhashi, Ikuno-ku, Osaka-city
Nearest station	Subway "Temmabashi"	Osaka Metro Midousuji line [Shinsaibashi]	Subway Sennichimae line, JR loop line Kintetsu line (Tsuruhashi)
Commuting time	About 24 minutes Walk→Subway Tanimachi Line →Walk	About 30minutes Walk→ Osaka Metro Midousuji line→ Walk	About 14minutes Walk → JR loop line → Walk
Transportation fee	commuting ticket (3months) : 27,020yen commuting ticket for students(3months) : 11,970yen	commuting ticket (3months) : 27,020 yen commuting ticket for students (3months) : 11,970 yen	commuting ticket (3months) : 11,300yen commuting ticket (3months) : 6,590yen
(Bicycle)	About 26 minutes	About 19minutes	About 11minutes
Fee			
Deposit etc	Deposit 69,000 to 105,000 yen (no refund) When moving in: House cleaning 25,000 yen	Deposit ¥67,000~76,000 (Non refundable) At the time of moving in :house cleaning fee ¥20,000	Deposit 1month rent fee (will be refunded at the time of moving out)
Rent	¥69,000~101,000/month (Included :maintenance, water fee)	¥67,000~72,000/month (Included :maintenance and water fee)	¥40,000~45,000/month (Included :maintenance, water and Internet fee)
Others	Electricity fee : Actual expenses Gas fee : Actual expenses Fire insurance ¥500 (1month)	Electricity fee : Actual expenses Gas fee : Actual expenses Fire insurance ¥500 (1month)	Electricity fee : Actual expenses Gas fee : Actual expenses Parking lot : ¥2,000/month (applicants)
Initial cost on move in date	Deposit ¥67,500~¥97,500 Rent at the current month(daily basis) + rent for next month Fire insurance ¥500 (not daily basis) House cleaning fee ¥25,000	Deposit ¥65,500~70,500 Rent at the current month(daily payment) + rent for next month Fire insurance ¥500 (not daily basis) House cleaning fee ¥20,000	Deposit 1month rent fee (will be refunded at the time of moving out) Rent of current month(daily payment) + rent for next month Fire insurance fee ¥13,000 (2 years)
Room, facility			
Room	21.41~33.59㎡	19.32~21.03㎡	14.72㎡~16.56㎡
Bath room	Separate	Separate	Unit bath
Mini kitchen	○	○	○
Internet	*Free Wi-Fi in all rooms (Available from the day you move in. No separate usage fee, penalty, etc.) *Wired can also be used.	Free Wi-Fi is available at all rooms. (Available from the day of move in, Separate charge / penalty is not needed) *Cable is available.	Free Wifi
Others	Air conditioner, shoe cupboard, 2-burner IH stove, bathroom dryer, bathroom vanity, bidet toilet seat, lighting, refrigerator, washing machine, bed, desk, chair, curtains (Futon: Can be purchased by proxy before moving in...8,500 yen) *Additional furniture PLAN Rent +1,000 yen Microwave, rice cooker Rent +3,000 yen TV, TV stand Rent +4,000 yen Microwave, rice cooker, TV, TV stand	Air conditioner, refrigerator, washing machine, lighting, Gas stove(Two burner),bathroom vanity, desk, chair, bed,curtain Futon:It is available to be on behalf of you before moving in...8,500 yen *Option furniture Rent + ¥1000 microwave, rice cooker Rent + ¥3000 TV, TV stand Rent + ¥4000 microwave, rice cooker, TV, TV stand	Air conditioner, refrigerator, closet, Electric cooking heater, bed, table, shoebox, curtain Optional furnitures: Futon...¥10,000, rice cooker...¥7,000 microwave...¥10,000
Shared facilities			
	Auto lock / security camera Elevator・Delivery box Free bicycle parking	Automatic lock entrance, Security camera, Elevator, Free bicycle parking area	Elevator, Coin laundry (washing machine, drying machine-charged), Automatic lock entrance, Manager is stationed, Delivery box

Terms of contract with temporary visitor visa

Chateau Astina Koraibashi	La Parte	Estemar Tsuruhashi2
None	None	None



[Twitter account]
@DAITETSU_JUTAKU

*The nearest station, commuting hours, transportation fee in this brochure is calculated from each school.
 *Information can be changed depending on the situation.
 *According to the local ordinance of Osaka City, oversized garbage disposal fee is required when disposing of Futons (Futon / blanket (up to 4 sheets) 200 yen). Please be careful when moving out.

	⑩R-Momodani	⑫R-NANBA SOUTH	⑬FC-Tezukayama
	Male・Female	Male・Female	Male・Female
Location			
Address	3-8-23 Katsuyamakita, Ikuno-ku, Osaka-city	1-7-14 Hanazonokita, Nishinari-ku, Osaka-city	2-8-14 Bandai, Sumiyoshi-ku, Osaka, Osaka
Nearest station	JR Loop Line [Momodani]	JR Loop Line (Shin-Imamiya)	Midousuji Line Nishitanabe Sta.
Commuting time	About 22 minutes Walk → JR loop line → Walk	About 19 minutes Walk → JR loop line → Walk	About 28 minutes Walk→Subway→Walk
Transportation fee	General Commuter Pass (3months) :11,300yen Student Commuter Pass (3months) :6,590yen	General Commuter Pass (3months) :11,090yen Student Commuter Pass (3months) :6,470yen	General Commuter Pass (3months) :25,940yen Student Commuter Pass (3months) :11,970yen
(Bicycle)	About12minutes	About20minutes	About 22 mins
Fee			
Deposit etc	①Deposit(Refundable): 0.5month rent fee + RLS ②Basic cleaning fee: ¥22,000 (when moving out) *RLS: Refer to the following "Others"		①Deposit(Refundable): 1month rent fee + RLS ②Dormitory fee: half a month rent fee + RLS ③Basic cleaning fee: ¥22,000 (when moving out) *RLS: Refer to the following "Others"
Rent	¥41,000~¥45,000 /month (Included: maintenance, water fee)	¥63,000 /month (Including: maintenance, water fee)	¥36,000~40,000 /month (Including: maintenance, water fee)
Others	RLS: 2,000 yen / month (rent guarantee, fire insurance, 24-hour emergency response, withdrawal fee), electricity fee: actual cost, gas fee: actual cost	RLS: 2,000 yen / month (rent guarantee, fire insurance, 24-hour emergency response, withdrawal fee), electricity fee: actual cost, gas fee: actual cost	RLS: 2,000 yen / month (rent guarantee, fire insurance, 24-hour emergency response), electricity fee: actual cost, gas fee: actual cost
Initial cost on move in date	Deposit: ¥43,000~ Entrance fee:21,500~ Previous rent: ①Daily payment rent of the current month + RLS and ②Rent for next month + RLS	Deposit: ¥65,000~ Entrance fee:32,500~ Previous rent: ①Daily payment rent of the current month + RLS and ②Rent for next month + RLS	Deposit: ¥36,000~ Entrance fee:18,000~ Previous rent: ①Daily payment rent of the current month + RLS and ②Rent for next month + RLS
Room, facility			
Room	16mf (1R)	22mf (1K)	15mf (1R)
Bath room	Unit Bath	Separate	Unit Bath
Mini kitchen	○		○
	Free Wi-Fi is available at all rooms. (available from the day of move in, separate charge/penalty is not needed)		
Others	Home appliances: 2-door refrigerator, microwave oven, vacuum cleaner, washing machine, air conditioner Furniture: bed frame, chairs, desks, closets, curtains, lighting Options: Futon 9,000 yen, rice cooker 7000 yen		
Shared facilities			
	Elevator, Auto lock, bicycle parking lot	Elevator, Auto lock, bicycle parking lot	Stairs, Bicycle parking space

Terms of contract with temporary visitor visa

R-Momodani	R-NANBA SOUTH	FC-Tezukayama
Rent: 3,000yen/day Utility costs:500yen/day	Rent: 3,300yen/day Utility costs:500yen/day	Rent: 3,300yen/day Utility costs:500yen/day
Admin fee:20,000yen Deposit:10,000yen(it will be returned when you move out)		

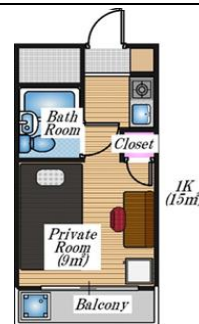
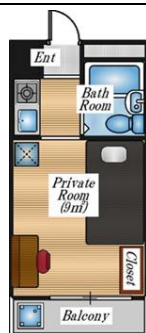

*The nearest station, commuting hours, transportation fee in this brochure is calculated from each school.
 *Information can be changed depending on the situation.
 *According to the local ordinance of Osaka City, oversized garbage disposal fee is required when disposing of Futons (Futon / blanket (up to 4 sheets) 200 yen). Please be careful when moving out.

	㊦M-Yamasaka	㊧Teradacho Heights	㊨R-NAKANO
	Male•Female	Male•Female	Male•Female
Location			
Address	2-11-6 Yamasaka, Higashisumiyoshi-ku, Osaka, Osaka	1-18-21 Ikunonishi, Ikuno-ku, Osaka, Osaka	3-4-5 Nakano, Higashisumiyoshi-ku, Osaka-city
Nearest station	JR Hanwa Line Minami-Tanabe Sta.	JR Osaka Loop Line Teradacho Sta.	OsakaMetro Tanimachi line (Komagawanakano)
Commuting time	About 15 mins Walk→JR→Walk	About 12 mins Walk 12 mins	About 20 mins Walk→Subway→Walk
Transportation fee	General Commuter Pas (3months) :11,300yen Student Commuter Pass (3months) :6,590yen	General Commuter Pas (3months) :11,300yen Student Commuter Pass (3months) :6,590yen	General Commuter Pass (3months) :27,020yen Student Commuter Pass (3months) :11,970yen
(Bicycle)	About 20 mins	About 5mins	About 23 mins
Fee			
Deposit etc	①Deposit(Refundable): 1month rent fee + RLS ②Domitory fee: a rent for half month + RLS *RLS:Refer to the following "Others" ③Basic cleaning fee: ¥22,000 (when moving out)※¥33,000 for ㊦and ㊧(when moving out)		
Rent	¥38,000~44,000/month	¥73,000~78,000 /month	¥68,000~72,000 /month
	(Including: maintenance, water fee)		(Including: maintenance, water fee, Electricity fee, Gas fee)
Others	RLS: 2,000 yen / month (rent guarantee, fire insurance, 24-hour emergency response) actual cost: electricity fee, gas fee		RLS: 2,000 yen/month Electricity fee and Gas fee: included in the rent
Initial cost on move in date	Deposit: ¥40,000~ Domitory fee: 20,000~ Previous rent: ①Daily payment rent of the current month + RLS and ②Rent for next month + RLS	Deposit: ¥75,000~ Domitory fee: 37,500~ Previous rent: ①Daily payment rent of the current month + RLS and ②Rent for next month + RLS	Deposit: ¥70,000~ Domitory fee: 34,000~ Previous rent: ①Daily payment rent of the current month + RLS and ②Rent for next month + RLS
Room, facility			
Room	20㎡ (1K)	28㎡ (2K•1LDK)	24.5~25.4㎡ (1K)
Bath room	Unit Bath	Separate	Separate
Mini kitchen	○	○	○
Internet	Free Wi-Fi is available at all rooms. (available from the day of move in, separate charge/penalty is not needed)		None
Others	*Home appliances: 2-door refrigerator, microwave oven, vacuum cleaner, washing machine, air conditioner(*) Furniture: bed frame, chairs, desks, closets, curtains, lighting Options: Futon 9,000 yen, rice cooker 7000 yen ※ M-Yamasaka does not have air conditioner heating, so a heater is installed.		
Shared facilities			
	Stairs,Bicycle parking space *5stories, stairs only, no elevator	Stairs,Auto lock,Bicycle parking space *5stories, stairs only, no elevator	Elevator,Auto lock,Bicycle parking space ※Built within 10 years

Terms of contract with temporary visitor visa

M-Yamasaka	Teradacho Heights	R-NAKANO
None	Rent: 3,500yen/day Utility costs:700yen/day	None
	Admin fee:20,000yen Deposit:10,000yen(it will be returned when you move out)	

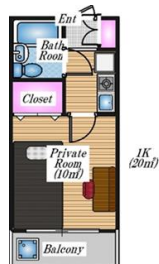

*The nearest station, commuting hours, transportation fee in this brochure is calculated from each school.
 *Information can be changed depending on the situation.
 *According to the local ordinance of Osaka City, oversized garbage disposal fee is required when disposing of Futons (Futon / blanket (up to 4 sheets) 200 yen). Please be careful when moving out.

	⑰Chateau Daikoku	⑱Chateau Daikoku2	⑲Chateau Kujo	㉑Chateau Kujo2
	Male・Female	Male・Female	Male・Female	Male・Female
Location				
Address	3-10-7, Daikoku, Naniwa-ku, Osaka-city	3-7-9, Daikoku, Naniwa-ku, Osaka-city	1-16-9, Kujo, Nishi-ku, Osaka-city	1-12-24, Kujo, Nishi-ku, Osaka-city
Nearest station	Subway Yotsubashi line (Daikoku cho)		Osaka-city bus [Kujo Shinmichi]	
Commuting time	Subway (about 20minutes) walk → subway → walk		Bus (about 15minutes) walk → bus → walk	
Transportation fee	commutation ticket for student (3months): ¥11,970 commutation ticket for student (6months): ¥22,680		commutation ticket for student (3months): ¥14,710 commutation ticket for student (6months): ¥27,860	
(Bicycle)	Not be able to go to school by bicycle		About 15minutes	
Fee				
Deposit etc	Deposit ¥0 House cleaning fee ¥25,000			
Rent	¥36,000~48,000/month (Included: maintenance and water fee)		¥36,000~43,000/month (Included: maintenance and water fee)	
Others	Electricity fee : Actual expenses Gas fee : Actual expenses Fire insurance : ¥500 (1month)			
Initial cost on move in date	Deposit ¥0 Rent at the current month (daily payment) + rent for next month Fire insurance ¥500 /month (not daily) Cleaning fee ¥25,000			
Room, facility				
Room	12.15~16.75㎡		12.6~13.43㎡	
Bath room	Unit Bath			
Mini kitchen	○			
Internet	Free Wi-Fi is available at all rooms. (Available from the day of move in, Separate charge / penalty is not needed) ※Cable is available.			
Others	Air conditioner, refrigerator, washing machine, lighting, IH cooking heater, desk, chair, folding bed, closet-hanger (Futon: proxy purchase before moving in is possible for those who need...¥8,500) (Additional option of furniture- microwave, rice cooker ... ¥10,000) Registration fee for bicycle parking area: ¥1,000 (first time only)			
Shared facilities				
	Elevator/ Janitor assigned/Entrance:self lock	Elevator/ Janitor assigned/Bicycle parking space	Elevator/ Janitor assigned/Bicycle parking space/Entrance:self lock	Elevator/ Janitor assigned/Bicycle parking space/Entrance: self lock

Terms of contract with temporary visitor visa

Chateau Daikoku	Chateau Daikoku2	Chateau Kujo	Chateau Kujo2
¥161,510~187,000/ 3months Electricity fee, Gas fee, Water fee, Internet fee are included. *The contract ends on the 25th for the final month.			

Daikoku

Daikoku 2

kujo

Kujo2

*The nearest station, commuting hours, transportation fee in this brochure is calculated from each school.

*Information can be changed depending on the situation.

*According to the local ordinance of Osaka City, oversized garbage disposal fee is required when disposing of Futons (Futon / blanket (up to 4 sheets) 200 yen). Please be careful when moving out.

	ORI Daikokucho	NA Kujo	V Shinosaka	R-SEKIME
	Male · Female			
Location				
Address	1-4-14 Ebisuhonmachi, Naniwa-ku, Osaka	2-1-10 Kujo, Nishi-ku, Osaka	2-15-2 Higashinakajima	3-9-20 Sekime, Joto-ku, Osaka
Nearest station	Daikokucho Station	Kujo Station	Nishinakajima Minamikata Station	Sekime Station
Commuting time	About 20 minutes	About 20 minutes	About 30 minutes	About 31 minutes
	Walk → Subway → Walk	Walk → Subway → Walk	Walk → Subway → Walk	Walk → Train → Walk
Transportation fee	Commuter Pass(3months) ¥11,970	Commuter Pass(3months) ¥11,970	Commuter Pass(3months) ¥11,970	Commuter Pass(3months) ¥10,150
	Commuter Pass(6months) ¥22,680	Commuter Pass(6months) ¥18,530	Commuter Pass(6months) ¥22,680	Commuter Pass(6months) ¥19,230
(Bicycle)	About 30 minutes	About 15 minutes	About 30 minutes	About 30 minutes
Fee				
Deposit etc	①Deposit(Refundable): 0.5month rent fee + RLS ②Dormitory fee: half a month rent fee + RLS ③Basic cleaning fee: ¥22,000 (when moving out) *RLS: Refer to the following "Others"			
Rent	¥58,000~73,000	¥48,000~52,000	¥41,000~43,000	¥41,000~45,000
	(Included: maintenance, water fee, Internet)			
Others	RLS: 2,000 yen / month (rent guarantee, fire insurance, 24-hour emergency response), electricity fee: actual cost, gas fee: actual cost			
Initial cost on move in date	Deposit: ¥60,000~ Entrance fee:30,000~ Previous rent: ①Daily payment rent of the current month + RLS and ② Rent for next month + RLS	Deposit: ¥50,000~ Entrance fee: 25,000~ Previous rent: ①Daily payment rent of the current month + RLS and ② Rent for next month + RLS	Deposit: ¥43,000~ Entrance fee:21,500~ Previous rent: ①Daily payment rent of the current month + RLS and ② Rent for next month + RLS	Deposit: ¥43,000~ Entrance fee:21,500~ Previous rent: ①Daily payment rent of the current month + RLS and ② Rent for next month + RLS
Room, facility				
Room	22~31㎡	18㎡	15~18㎡	15~20㎡
Bath room	Separate	Unit bath		
Mini kitchen	○			
Internet	Free WiFi is available at all rooms. Available from the day of move in. No additional fee nor penalty fee.			
Others	Home appliances: Air conditioner, 2-door refrigerator, microwave oven, washing machine (excluding V ShinOsaka) Furniture: bed frame, chair, desk, closet, curtain, lighting Wifi: Free Other(New):Futon ¥9,000, Ricecooker ¥7,000, Name stamp set ¥2,000 (Stamp + Stamp Case)			
Shared facilities				
	Elevator, bicycle parking lot	Air conditioner, refrigerator, microwave, Vacuum cleaner, washing machine, bed, chair, desk, closet hangers, curtain, lightning	Air conditioner, refrigerator, microwave, Vacuum cleaner, washing machine, bed, chair, desk, closet hangers, curtain, lightning, sharing coin laundry	Automatic door lock, stairs, Bicycle parking lot (limited on the number of vehicles)

Terms of contact with temporary visitor visa (3month)

ORI Daikokucho	NA Kujo	V Shinosaka	R-SEKIME
Rent: 3,300yen/day Utility costs:500yen/day	Rent: 3,300yen/day Utility costs:500yen/day	Rent: 2,500yen/day Utility costs:500yen/day	Rent: 3,000yen/day Utility costs:500yen/day
Admin fee:20,000yen Deposit:10,000yen(it will be returned when you move out)			



*The nearest station, commuting hours, transportation fee in this brochure is calculated from each school.

*Information can be changed depending on the situation.

*According to the local ordinance of Osaka City, oversized garbage disposal fee is required when disposing of Futons (Futon / blanket (up to 4 sheets) 200 yen). Please be careful when moving out.

	🏰Chateau Hanazono 3	🏰Chateau Hanazono 4	🏰Chateau Hanazono7	
	Male・Female		Male・Female / (1person)	Male・Female / (2person)
Location				
Address	2-5-3, Hanazono kita, Nishi-ku, Osaka-city	1-10-10, Asahi, Nishi-ku, Osaka-city	1-6-21, Tsurumibashi, Nishinari-ku, Osaka-city	
Nearest station	Subway Yotsubashi line [Hanazonocho]			
Commuting time	To Osaka YMCA Gakuin:About 20minutes Walk → Subway Yotsubashi line → Subway Midosuji line → Walk To Osaka YMCA International college:About 22minutes Walk → Subway Yotsubashi line → Walk			
Transportation fee	commuting ticket (3months) :27,020yen commuting ticket for students (3months) :11,970yen			
(Bicycle)	About 17 minutes			
Fee				Per 1person
Deposit etc	Deposit ¥0 At the time of moving in :house cleaning fee ¥25,000			Deposit ¥20,000(Non refundable) At the time of moving in :house cleaning fee ¥15000
Rent	¥31,000~38,000yen/month (Included:maintenance and water fee)	¥33,000~38,000yen/month (Included:maintenance and water fee)	① ¥35,000~45,000yen/month (Included:maintenance and water fee) ② ¥44,000~45,000/month (Included:maintenance and water fee)	¥28,000~30,000yen/month (Included:maintenance and water fee)
Others	Electricity fee: Actual expenses Gas fee:Actual expenses Fire insurance fee ¥500/month			Electricity fee: Actual expenses Gas fee:Actual expenses Fire insurance fee ¥250/month
Initial cost on move in date	Deposit ¥0 Rent at the current month (daily basis) + rent for next month Fire insurance fee ¥500 (Not daily basis) House cleaning fee ¥25,000			Deposit ¥20000 Rent at the current month (daily basis) + rent for next month Fire insurance fee ¥250 (Not daily basis)
Room, facility				
Room	11.52~12.50㎡	13.36~14.79㎡	①1R 12.47~14.21㎡②1K 18.60~19.90㎡	2K 37.41㎡
Bath room	Unit bath			
Mini kitchen	○			
Internet	Free Wi-Fi is available at all rooms (Available from the day of move in. No additional fee nor penalty fee) ※ Cable is available			
Others	Air conditioner, refrigerator, washing machine, lightning, IH cooking heater, desk, chair, bed, wardrobe (futon:proxy purchase before moving in is available...8,500yen) (Additional option of furniture-microwave, rice cooker:10,000yen) Registration fee for bicycle parking area:1000yen (only first time)			Air conditioner×2, refrigerator, washing machine, lightning, IHcooking heater, bed×2, desk×2, chair×2, wardrobe×2 (futon:proxy purchase before moving in is available...8,500yen) (Additional option of furniture-microwave, rice cooker:10,000yen)
Shared facilities				
	Elevator / Bicycle parking areaBicycle parking lot (prior application required) Registration fee: 1,000yen(first time only)/ Janitor assigned			

Terms of contract with temporary visitor visa

Chateau Hanazono 3	Chateau Hanazono 4	Chateau Hanazono7
¥143,950 ~ 167,000/ 3months Electricity fee, Gas fee, Water fee, Internet fee are included. *The contract ends on the 25th for the final month.		Only 12.47㎡ room, ¥141,320 ~ 164,000/ 3months Electricity fee, Gas fee, Water fee, Internet fee are included. *The contract ends on the 25th for the final month.

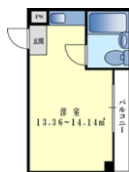
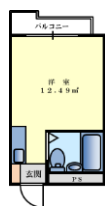

Rental furniture
Long term contract 2sets ¥10,000
Short term contract:free

